

TANDEMBOX antaro

Rectangular rail with a clear design
throughout the whole range

www.blum.com

 **blum**[®]







Minimalist design.

Proven technology.

TANDEMBOX antaro

The TANDEMBOX drawer system has been impressing furniture users and manufacturers with its proven technology for many years. The TANDEMBOX antaro programme line offers a wide range of design possibilities and minimalist design options. TANDEMBOX antaro is all about clean lines, whether it's open with a gallery or a closed drawer box with a side design element.

All components are colour-coordinated.
Minimalist design meets proven technology.
That is TANDEMBOX antaro.

- 4–7 **Design**
- 8–15 **Programme**
- 16–17 **Assembly**
- 18–19 **Ideas for practical kitchens**
- 20–23 **Technological developments**
- 24–25 **Motion technologies**
- 26–73 **Ordering and planning information**
- 74–75 **Blum**



Open, or with a design element. Consistent design

TANDEMBOX antaro starts with your choice of an open drawer, characterised by a rectangular gallery or a closed drawer with a side design element made from glass, metal or other material such as wood.

 **blum**



The design: three colours – one style



Minimalist style with a customised colour concept

The minimalist design of the TANDEMBOX antaro is based on clean lines and a simple colour scheme. All plastic components are coordinated to match the respective drawer side colour.

The colour programme includes three steel variants: silk white, white aluminium and terra black.





You have the choice.

And all options are available

With TANDEMBOX antaro, you can realise all of your design aspirations. From inner drawers, high fronted pull-outs to open or closed drawers. Even special applications such as the SPACE TOWER larder unit, the Blum sink pull-out or the SPACE CORNER corner solution are possible.

The programme – One system for all applications

 **blum**



The programme – Living room re-invented

blum

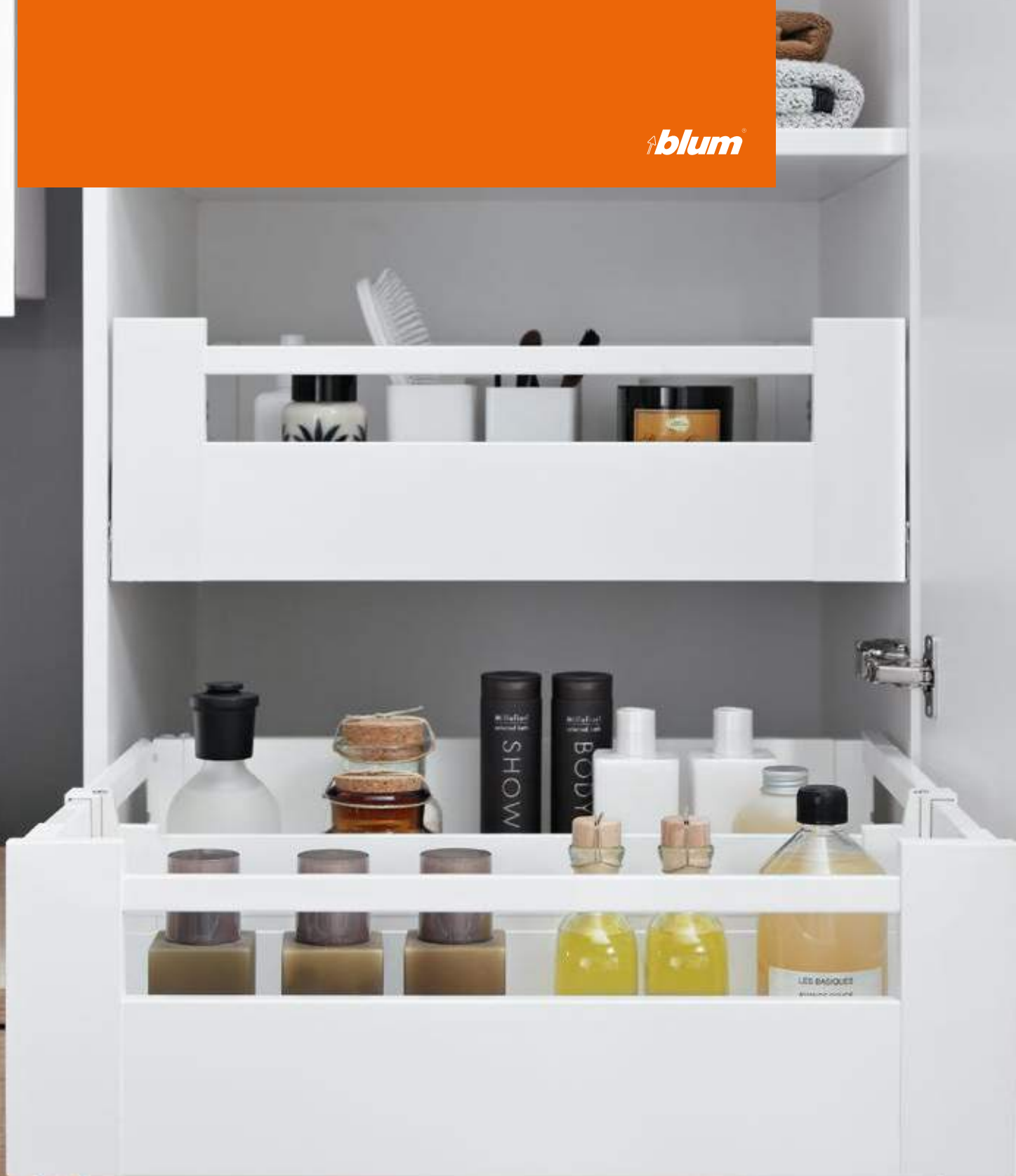



TANDEMBOX antaro offers a complete programme for pull-outs and drawers. Whether in the kitchen, bathroom or living area – all applications are possible with TANDEMBOX antaro.

Nominal lengths	270–650 mm
Cabinet widths	275–1200 mm
Drawer side heights	N (68.5 mm) M (83.6 mm) K (115.6 mm)



Design elements – Use to attain a unique style

By using design elements you will be able to fully enclose the drawer & simultaneously present a style statement. The elements you add can reflect your design aspirations. You can choose from Blum design elements (glass or metal). There are of course, many other possibilities (eg wood) you could use to express your ideas.



Glass design elements



Clear glass



Frosted glass

Metal design elements in three drawer side colours



Terra black



RAL 9006 grey (white aluminium)



Silk white

Your own ideas, e.g. using wood can easily be put into practice



The programme – Inner dividing system

blum





Practical organisation

The ORGA-LINE inner dividing system is not only practical, but also matches the shape and colour scheme of TANDEMBOX antaro. Storage items are perfectly organised using flexible longside and cross dividers. Stainless steel drip trays in the drawers provide high-quality organisation. Very practical: The containers are easy to remove and are dishwasher safe.

See the ORGA-LINE brochure for more information about this practical organisational tool.

Gallery and front are connected
via INSERTA technology



Assembly – Simple and tool-free

blum



Back gallery rails clip on easily.



Front tilt adjustment



Design element assembly is very easy. Simply slide in and connect to the back locking piece.

It is important to us that assembly is as quick and easy as possible, e.g. using the proven INSERTA technology – completely tool-free.

The TANDEMBOX program line is based on the established cabinet profile. This is a real advantage especially when you are assembling different programme lines. The drilling and cutting dimensions remain the same and familiar assembly devices support efficient assembly.



View assembly video
> www.blum.com/172HZO

DYNAMIC SPACE – Ideas from Blum for practical kitchens

The three important features of a practical kitchen include good workflows, enough storage space and high ease of use – at Blum, this means: workflow, space and motion. With DYNAMIC SPACE, we offer helpful ideas, suggestions and solutions for making today's kitchen even more practical.

blum®



For more information about practical kitchens

<http://www.blum.com/ideas>

 **DYNAMIC SPACE®**

Ideas from Blum for practical kitchens

Workflow – Convenience

Thanks to full extension drawers & pull-outs, even those items in the farthest corner are visible and easy to reach. The right ORGA-LINE inner dividing system provides additional organisation and overview. In this way, TANDEMBOX antaro supports simple workflows in the kitchen.



Space – Optimisation

TANDEMBOX antaro can also be used as an enclosed drawer with glass or metal design elements. Products are easier to stack, thus creating up to 55% more storage space. You can also achieve special solutions such as the Blum sink pull-out with TANDEMBOX antaro, gaining additional storage space from previously unused areas.



Motion – Quality

The BLUMOTION function is integrated into TANDEMBOX cabinet profiles. Thus pull-outs always close silently and effortlessly regardless of how much force is used for closing. TANDEMBOX antaro can also be equipped with the SERVO-DRIVE electrical opening support system. A light touch on the front is enough and pull-outs open as if by themselves.



Easy opening

Lower opening forces and an even smoother transition to the feather-light glide improve performance from the moment you open the pull-out.



Outstanding quality

The improved drawer side combined with a new front fixing bracket has noticeably increased the stability of the product.



Optimised feather-light glide

Components in the drawer side and cabinet profile have been further developed to optimise the feather-light glide of TANDEMBOX and the smooth running action.





Technological developments

Over the course of the development of TIP-ON BLUMOTION for TANDEMBOX, some of the main functions of the existing system were also optimised. These tangible improvements to the technology mean even greater quality of motion.

TANDEMBOX cabinet profile

All TANDEMBOX lines are based on the tried and tested TANDEMBOX cabinet profile. The feather-light gliding motion has been impressing users for many years. Key to this success are the low-friction cylindrical rollers that guarantee top quality of motion for load bearing classes of 30 kg and 65 kg, for the life of the furniture. Numerous motion and load bearing tests are carried out to ensure this quality standard is maintained.

 blum®







**Fascinating action when
opening and closing**

blum



BLUMOTION

With BLUMOTION, pull-outs close silently and effortlessly. It doesn't matter how much force is used to close drawers and pull-outs or how heavily laden they are.

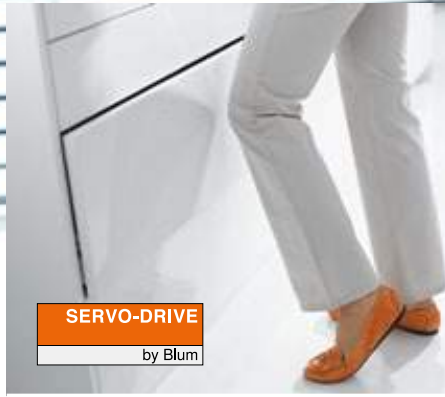

SERVO-DRIVE

A light touch on a handle-less front or a light pull of the handle – that's all it takes to open drawers and pull-outs with the SERVO-DRIVE electrical motion support system: And you always have integrated BLUMOTION.



TIP-ON BLUMOTION

TIP-ON BLUMOTION combines the advantages of the TIP-ON mechanical opening support system with tried and tested BLUMOTION dampening. Simply, push the drawer shut and then BLUMOTION cuts in for a silent and effortless closing.



Standard cabinet

High fronted pull-out

	High fronted pull-out – gallery – D – M drawer side 28	
	High fronted pull-out – gallery – D – K drawer side 30	
	High fronted pull-out – gallery – C – M drawer side 32	
	Design element – D – M drawer side 48	
	Design element – C – M drawer side 49	
	High fronted pull-out with an alu frame – gallery – D – M drawer side 34	
	High fronted pull-out with an alu frame – gallery – C – M drawer side 34	

Inner pull-out

	Inner pull-out – gallery – D – M drawer side 36	
	Inner pull-out – gallery – D – K drawer side 38	
	Inner pull-out – gallery – C – M drawer side 40	
	Design element – D – M drawer side 48	
	Design element – C – M drawer side 49	

Corner cabinet

	SPACE CORNER with SYNCROMOTION – gallery – D/C – M drawer side 42	
	SPACE CORNER with rigid fronts – gallery – D – M drawer side 43	

Sink cabinet

	Sink pull-out – gallery – D – M drawer side 44	
	Sink pull-out – gallery – C – M drawer side 46	

Standard cabinet

Drawer		Inner drawer	
	Drawer – K 50 		Inner drawer – K 56
	Drawer – M 52 		Inner drawer – M 58
	Drawer – N 54 		

Corner cabinet

	SPACE CORNER with SYNCROMOTION – M 42 	
	SPACE CORNER with rigid fronts – M 43 	

Accessories

Front/base stabiliser	60
Steel back	60
Back and gallery fixing – B – M drawer side	61
Flexible gallery fixing	62

Recommendation – colour combination of the components

	TS	R 9006	SW
	Terra black	RAL 9006 grey (white aluminium)	Silk white
S			
Black	■		
SW			
Silk white			■
WGR			
White grey		■	

TANDEMBOX antaro



High fronted pull-out – gallery – D – M drawer side

Product

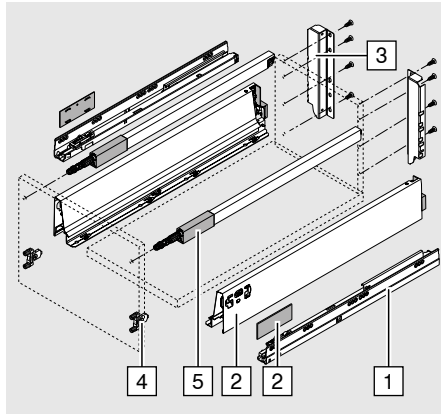

Space requirement

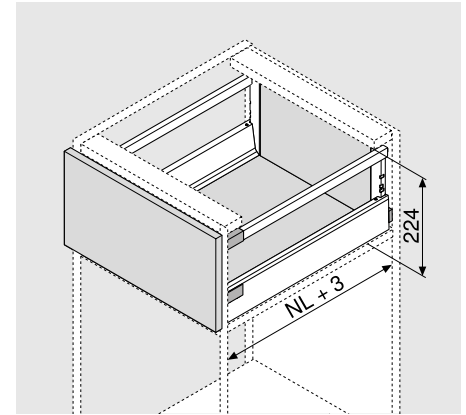

NL Nominal length

Order specification

1	Cabinet profiles left/right		
		BLUMOTION*	
	NL	30 kg	65 kg
	270 mm	578.2701B	
	300 mm	578.3001B	
	350 mm	578.3501B	
	400 mm	578.4001B	
	450 mm	578.4501B	576.4501B
	500 mm	578.5001B	576.5001B
	550 mm	578.5501B	576.5501B
	600 mm	578.6001B	576.6001B
	650 mm		576.6501B

* Suitable for SERVO-DRIVE

2	Drawer sides and cover caps left/right		
	Colour variants	TS	R 9006 SW
	NL		Steel
	270 mm	378M2702SA	
	300 mm	378M3002SA	
	350 mm	378M3502SA	
	400 mm	378M4002SA	
	450 mm	378M4502SA	
	500 mm	378M5002SA	
	550 mm	378M5502SA	
	600 mm	378M6002SA	
	650 mm	378M6502SA	

3	Back fixing and gallery fixing left/right		
	Colour variants	TS	R 9006 SW
			Steel
			Z30D000SL
	Steel back		60

4	Front fixing bracket		
	INSERTA version	2 x	ZSF.39A2
	Screw-on version	2 x	ZSF.35A2
	Knock-in version	2 x	ZSF.36A2

5	Longside gallery rail left/right		
	Colour variants	TS	R 9006 SW
	NL		Steel
	270 mm		ZRG.207RSIC
	300 mm		ZRG.237RSIC
	350 mm		ZRG.287RSIC
	400 mm		ZRG.337RSIC
	450 mm		ZRG.387RSIC
	500 mm		ZRG.437RSIC
	550 mm		ZRG.487RSIC
600 mm		ZRG.537RSIC	
650 mm		ZRG.587RSIC	

High fronted pull-out – gallery – D – M drawer side

TANDEMBOX antaro



Planning information

Space requirements in cabinet

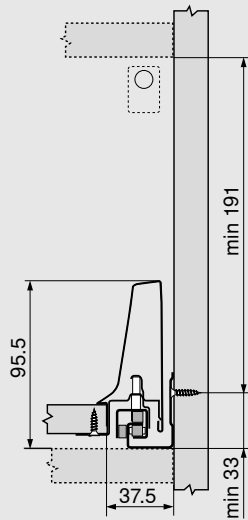

Front dimensions

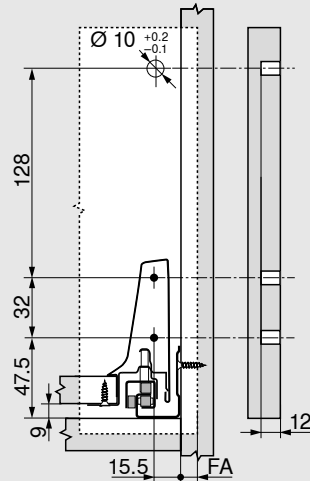

FA Front overlay

Back installation dimensions

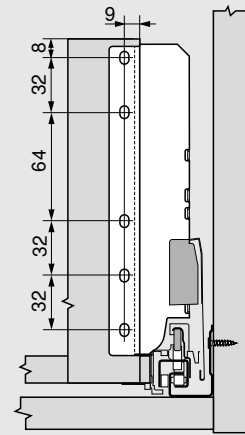

Cutting dim. for 16 mm chipboard

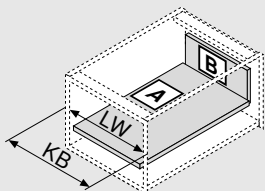

- KB Cabinet width
- LW Inner cabinet width
- NL Nominal length

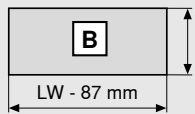

Back
199 mm

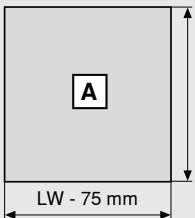

Base
Chipboard back
NL - 24 mm
Steel back
NL - 22 mm

TANDEMBOX antaro



High fronted pull-out – gallery – D – K drawer side

Product

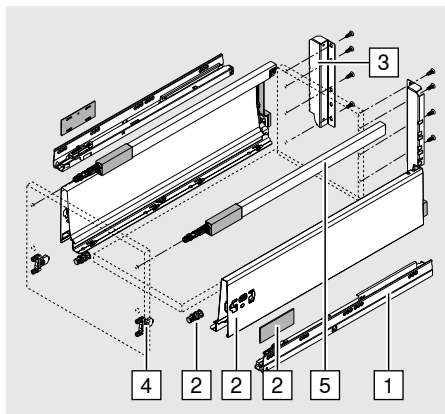

Space requirement

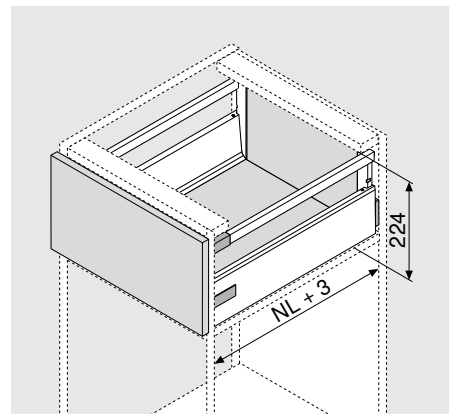

NL Nominal length

Order specification

1	Cabinet profiles left/right		
		BLUMOTION*	
	NL	30 kg	65 kg
	270 mm	578.2701B	
	300 mm	578.3001B	
	350 mm	578.3501B	
	400 mm	578.4001B	
	450 mm	578.4501B	576.4501B
	500 mm	578.5001B	576.5001B
	550 mm	578.5501B	576.5501B
	600 mm	578.6001B	576.6001B
	650 mm		576.6501B

* Suitable for SERVO-DRIVE

2	Drawer sides and cover caps left/right		
	Colour variants	TS	R 9006 SW
	NL		Steel
	270 mm	378K2702SA	
	300 mm	378K3002SA	
	350 mm	378K3502SA	
	400 mm	378K4002SA	
	450 mm	378K4502SA	
	500 mm	378K5002SA	
	550 mm	378K5502SA	
	600 mm	378K6002SA	
	650 mm	378K6502SA	

3	Back fixing and gallery fixing left/right		
	Colour variants	TS	R 9006 SW
			Steel
			Z30D000SL
	Steel back		60

4	Front fixing bracket		
	INSERTA version	2 x	ZSF.39A2
	Screw-on version	2 x	ZSF.35A2
	Knock-in version	2 x	ZSF.36A2

5	Longside gallery rail left/right		
	Colour variants	TS	R 9006 SW
	NL		Steel
	270 mm		ZRG.207RSIC
	300 mm		ZRG.237RSIC
	350 mm		ZRG.287RSIC
	400 mm		ZRG.337RSIC
	450 mm		ZRG.387RSIC
	500 mm		ZRG.437RSIC
	550 mm		ZRG.487RSIC
600 mm		ZRG.537RSIC	
650 mm		ZRG.587RSIC	

High fronted pull-out – gallery – D – K drawer side

TANDEMBOX antaro



Planning information

Space requirements in cabinet

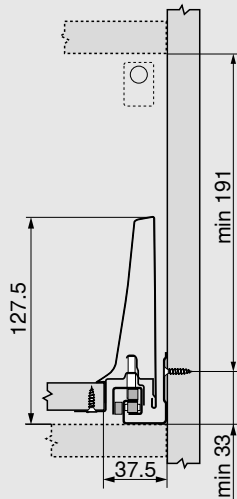

Front dimensions

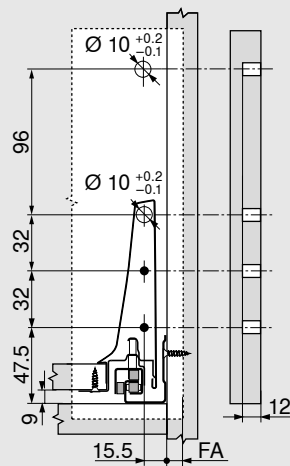

FA Front overlay

Back installation dimensions

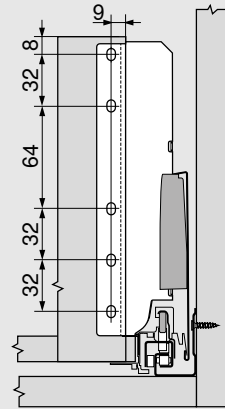

Cutting dim. for 16 mm chipboard

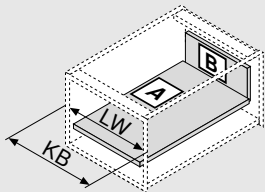

- KB Cabinet width
- LW Inner cabinet width
- NL Nominal length

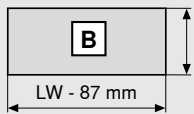

Back
199 mm

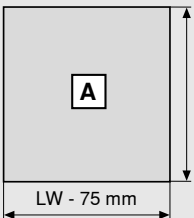

Base
Chipboard back
NL - 24 mm
Steel back
NL - 22 mm

TANDEMBOX antaro



High fronted pull-out – gallery – C – M drawer side

Product

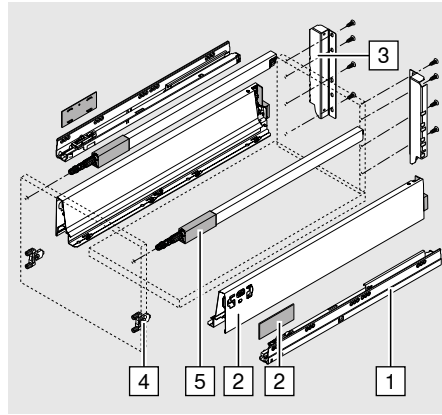

Space requirement

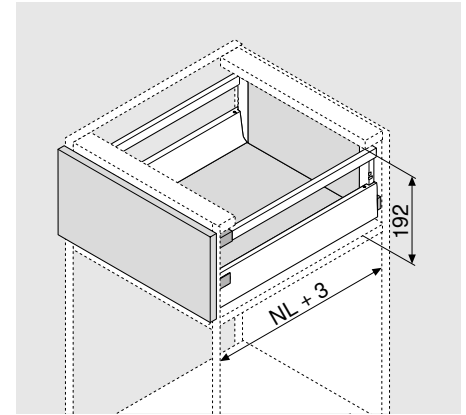

NL Nominal length

Order specification

1	Cabinet profiles left/right		
		BLUMOTION*	
	NL	30 kg	65 kg
	270 mm	578.2701B	
	300 mm	578.3001B	
	350 mm	578.3501B	
	400 mm	578.4001B	
	450 mm	578.4501B	576.4501B
	500 mm	578.5001B	576.5001B
	550 mm	578.5501B	576.5501B
	600 mm	578.6001B	576.6001B
	650 mm		576.6501B

* Suitable for SERVO-DRIVE

2	Drawer sides and cover caps left/right		
	Colour variants	TS	R 9006 SW
	NL		Steel
	270 mm	378M2702SA	
	300 mm	378M3002SA	
	350 mm	378M3502SA	
	400 mm	378M4002SA	
	450 mm	378M4502SA	
	500 mm	378M5002SA	
	550 mm	378M5502SA	
	600 mm	378M6002SA	
	650 mm	378M6502SA	

3	Back fixing and gallery fixing left/right		
	Colour variants	TS	R 9006 SW
			Steel
			Z30C000S
	Steel back		60

4	Front fixing bracket		
	INSERTA version	2 x	ZSF.39A2
	Screw-on version	2 x	ZSF.35A2
	Knock-in version	2 x	ZSF.36A2

5	Longside gallery rail left/right		
	Colour variants	TS	R 9006 SW
	NL		Steel
	270 mm	ZRG.207RSIC	
	300 mm	ZRG.237RSIC	
	350 mm	ZRG.287RSIC	
	400 mm	ZRG.337RSIC	
	450 mm	ZRG.387RSIC	
	500 mm	ZRG.437RSIC	
	550 mm	ZRG.487RSIC	
600 mm	ZRG.537RSIC		
650 mm	ZRG.587RSIC		

High fronted pull-out – gallery – C – M drawer side

TANDEMBOX antaro



Planning information

Space requirements in cabinet

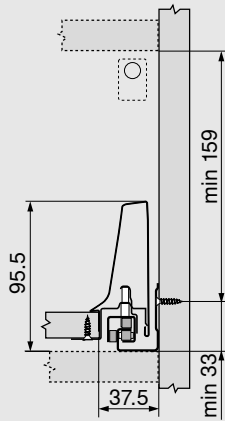

Front dimensions

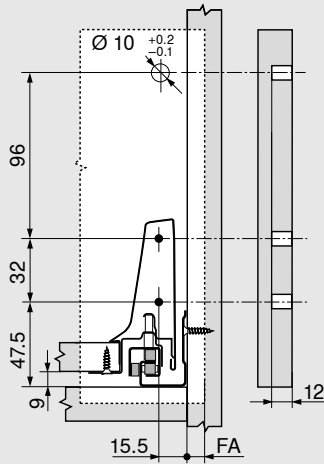

FA Front overlay

Back installation dimensions

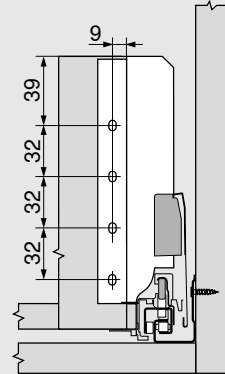

Cutting dim. for 16 mm chipboard

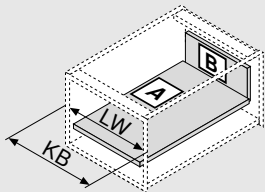

- KB Cabinet width
- LW Inner cabinet width
- NL Nominal length

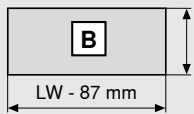

Back
167 mm

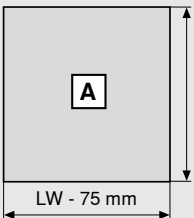

Base
Chipboard back
NL - 24 mm
Steel back
NL - 22 mm

TANDEMBOX antaro



High fronted pull-out with an alu frame – gallery – D/C – M drawer side

Product

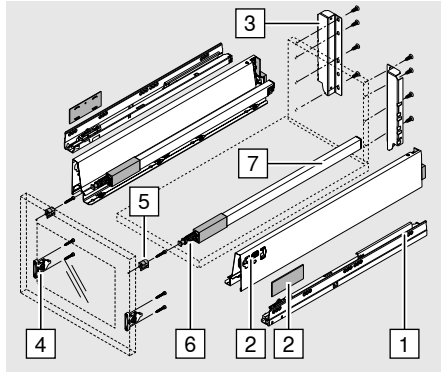

Space requirement

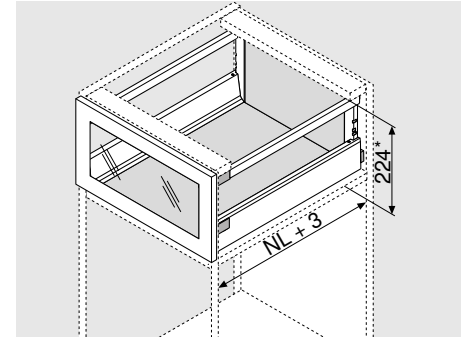

* Height C 192

NL Nominal length

Order specification

1	Cabinet profiles left/right		
		BLUMOTION*	
	NL	30 kg	65 kg
	270 mm	578.2701B	
	300 mm	578.3001B	
	350 mm	578.3501B	
	400 mm	578.4001B	
	450 mm	578.4501B	576.4501B
	500 mm	578.5001B	576.5001B
	550 mm	578.5501B	576.5501B
	600 mm	578.6001B	576.6001B
	650 mm		576.6501B

* Suitable for SERVO-DRIVE

4	Front fixing bracket		
	Screw-on version	2 x	ZSF.35A2

5	Adapter for alu frames, symmetrical		
	Colour variants		natural/white
			Nylon
		2 x	ZRF.2200.01

6	Gallery head		
	Colour variants		natural/white
			Nylon
		2 x	ZRG.000R5F

2	Drawer sides and cover caps left/right			
	Colour variants	TS	R 9006	SW
	NL			Steel
	270 mm			378M2702SA
	300 mm			378M3002SA
	350 mm			378M3502SA
	400 mm			378M4002SA
	450 mm			378M4502SA
	500 mm			378M5002SA
	550 mm			378M5502SA
	600 mm			378M6002SA
	650 mm			378M6502SA

7	Longside gallery rail left/right			
	Colour variants	TS	R 9006	SW
	NL			Steel
	270 mm			ZRG.207RSIC
	300 mm			ZRG.237RSIC
	350 mm			ZRG.287RSIC
	400 mm			ZRG.337RSIC
	450 mm			ZRG.387RSIC
	500 mm			ZRG.437RSIC
	550 mm			ZRG.487RSIC
600 mm			ZRG.537RSIC	
650 mm			ZRG.587RSIC	

3	Back fixing and gallery fixing left/right			
	Colour variants	TS	R 9006	SW
				Steel
	Height D			Z30D000SL
	Height C			Z30C000S
	Steel back			60

High fronted pull-out with an alu frame – gallery – D/C – M drawer side

TANDEMBOX antaro



Planning information

Space requirements in cabinet	Front dimensions	Back installation dimensions	
		<p>Height D</p>	<p>Height C</p>
* Height C min 159	* Height C 96 FA Front overlay		

Cutting dim. for 16 mm chipboard

KB Cabinet width
LW Inner cabinet width
NL Nominal length

	<p>Back 199 mm*</p>
	<p>Base Chipboard back NL - 24 mm Steel back NL - 22 mm</p>

* Height C 167

TANDEMBOX antaro



Inner pull-out – gallery – D – M drawer side

Product

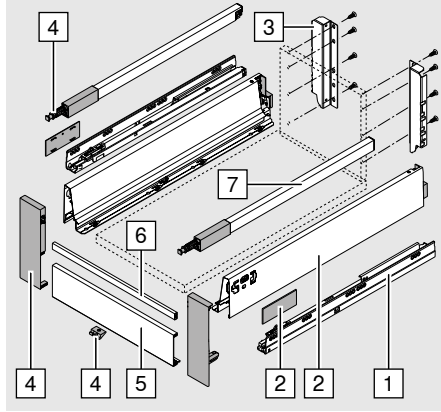

Space requirement

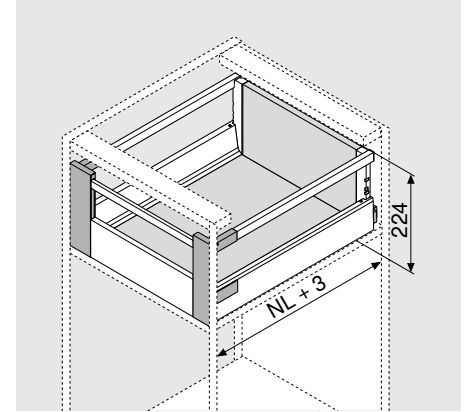

NL Nominal length

Order specification

1	Cabinet profiles left/right		
		BLUMOTION*	
	NL	30 kg	65 kg
	270 mm	578.2701B	
	300 mm	578.3001B	
	350 mm	578.3501B	
	400 mm	578.4001B	
	450 mm	578.4501B	576.4501B
	500 mm	578.5001B	576.5001B
	550 mm	578.5501B	576.5501B
	600 mm	578.6001B	576.6001B
	650 mm		576.6501B

* Suitable for SERVO-DRIVE

2	Drawer sides and cover caps left/right			
	Colour variants	TS	R 9006	SW
NL		Steel		
270 mm		378M2702SA		
300 mm		378M3002SA		
350 mm		378M3502SA		
400 mm		378M4002SA		
450 mm		378M4502SA		
500 mm		378M5002SA		
550 mm		378M5502SA		
600 mm		378M6002SA		
650 mm		378M6502SA		

3	Back fixing and gallery fixing left/right			
	Colour variants	TS	R 9006	SW
		Steel		
		Z30D000SL		
Steel back				60

4	Front fixing left/right			
	Colour variants	S	WGR	SW
		Nylon		
		ZIF.74D0		
	Incl. locking piece Z31A0008			
	Incl. 2x gallery heads ZRG.000R5F			

5	Front section			
	Colour variants	TS	R 9006	SW
		Aluminium		
		Z31L1036A		
	For cutting to size			

6	Cross gallery			
	Colour variants	TS	R 9006	SW
		Aluminium		
		ZRG.1046Z		
	For cutting to size			

7	Longside gallery rail left/right			
	Colour variants	TS	R 9006	SW
NL		Steel		
270 mm		ZRG.207RSIC		
300 mm		ZRG.237RSIC		
350 mm		ZRG.287RSIC		
400 mm		ZRG.337RSIC		
450 mm		ZRG.387RSIC		
500 mm		ZRG.437RSIC		
550 mm		ZRG.487RSIC		
600 mm		ZRG.537RSIC		
650 mm		ZRG.587RSIC		

Planning information

Space requirements in cabinet

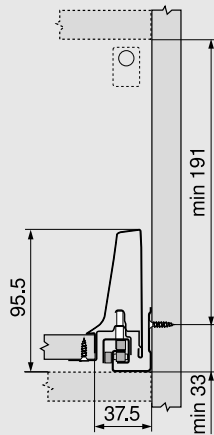

Back installation dimensions

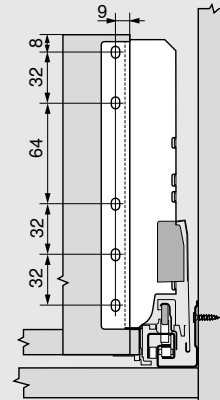

Cutting dim. for 16 mm chipboard

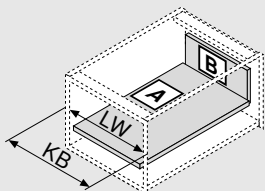

- KB Cabinet width
- LW Inner cabinet width
- NL Nominal length

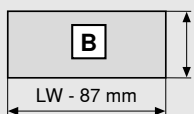

Back
199 mm

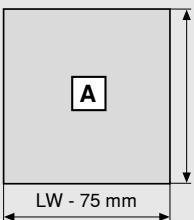

Base
Chipboard back
NL - 24 mm
Steel back
NL - 22 mm

Front piece for cutting to size

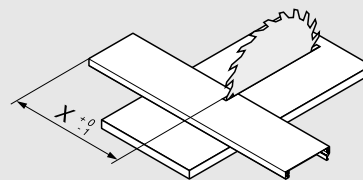

$X = LW - 132$

Cross gallery for cutting to size

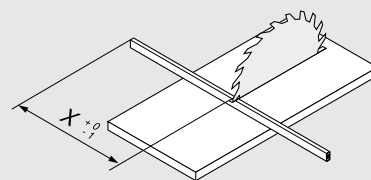

$X = LW - 122$

TANDEMBOX antaro



Inner pull-out – gallery – D – K drawer side

Product

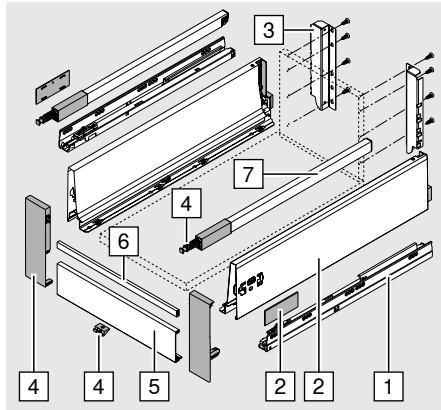

Space requirement

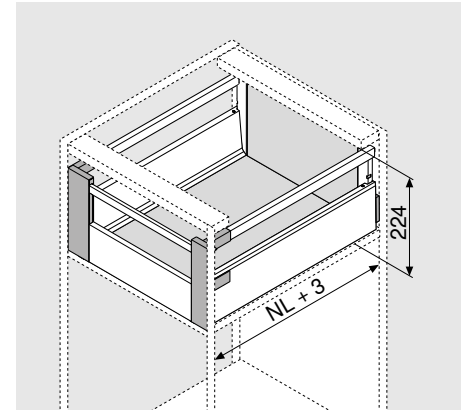

NL Nominal length

Order specification

1	Cabinet profiles left/right		
		BLUMOTION*	
	NL	30 kg	65 kg
	270 mm	578.2701B	
	300 mm	578.3001B	
	350 mm	578.3501B	
	400 mm	578.4001B	
	450 mm	578.4501B	576.4501B
	500 mm	578.5001B	576.5001B
	550 mm	578.5501B	576.5501B
	600 mm	578.6001B	576.6001B
	650 mm		576.6501B

* Suitable for SERVO-DRIVE

2	Drawer sides and cover caps left/right		
	Colour variants	TS	R 9006
NL		Steel	
270 mm		378K2702SA	
300 mm		378K3002SA	
350 mm		378K3502SA	
400 mm		378K4002SA	
450 mm		378K4502SA	
500 mm		378K5002SA	
550 mm		378K5502SA	
600 mm		378K6002SA	
650 mm		378K6502SA	

3	Back fixing and gallery fixing left/right		
	Colour variants	TS	R 9006
		Steel	
		Z30D000SL	
Steel back			60

4	Front fixing left/right		
	Colour variants	S	WGR
		Nylon	
		ZIF.74D0	
	Incl. locking piece Z31A0008		
	Incl. 2x gallery heads ZRG.000R5F		

5	Front section		
	Colour variants	TS	R 9006
		Aluminium	
		Z31L1036A	
	For cutting to size		

6	Cross gallery		
	Colour variants	TS	R 9006
		Aluminium	
		ZRG.1046Z	
	For cutting to size		

7	Longside gallery rail left/right		
	Colour variants	TS	R 9006
NL		Steel	
270 mm		ZRG.207RSIC	
300 mm		ZRG.237RSIC	
350 mm		ZRG.287RSIC	
400 mm		ZRG.337RSIC	
450 mm		ZRG.387RSIC	
500 mm		ZRG.437RSIC	
550 mm		ZRG.487RSIC	
600 mm		ZRG.537RSIC	
650 mm		ZRG.587RSIC	

Planning information

Space requirements in cabinet

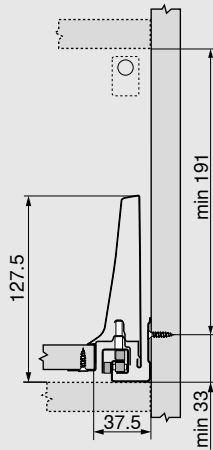

Back installation dimensions

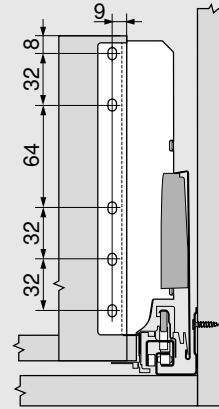

Cutting dim. for 16 mm chipboard

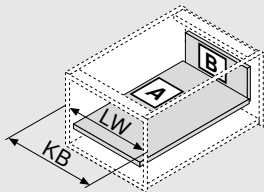

- KB Cabinet width
- LW Inner cabinet width
- NL Nominal length

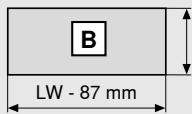

- Back**
- 199 mm

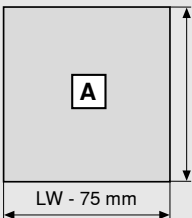

- Base**
- Chipboard back
- NL - 24 mm
- Steel back
- NL - 22 mm

Front piece for cutting to size

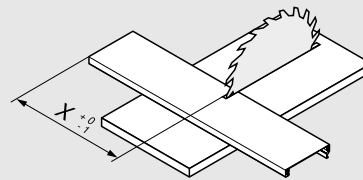

$X = LW - 132$

Cross gallery for cutting to size

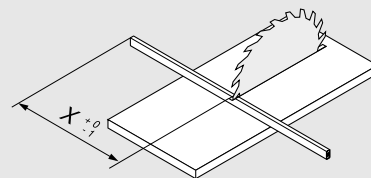

$X = LW - 122$

TANDEMBOX antaro



Inner pull-out – gallery – C – M drawer side

Product

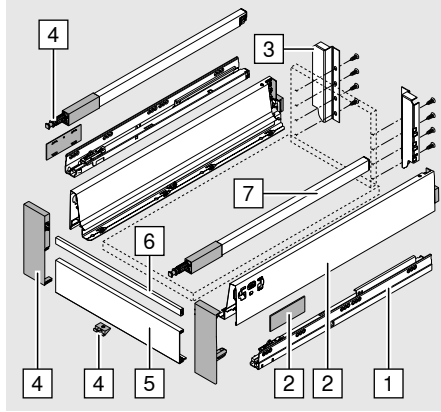

Space requirement

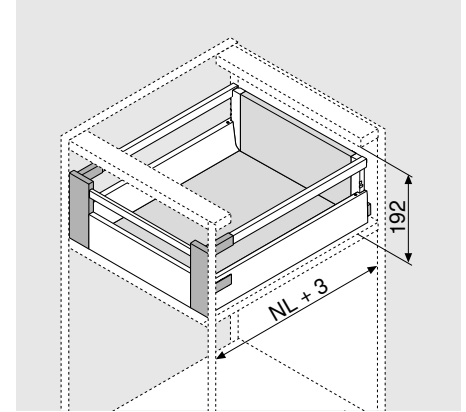

NL Nominal length

Order specification

1	Cabinet profiles left/right		
		BLUMOTION*	
	NL	30 kg	65 kg
	270 mm	578.2701B	
	300 mm	578.3001B	
	350 mm	578.3501B	
	400 mm	578.4001B	
	450 mm	578.4501B	576.4501B
	500 mm	578.5001B	576.5001B
	550 mm	578.5501B	576.5501B
	600 mm	578.6001B	576.6001B
	650 mm		576.6501B

* Suitable for SERVO-DRIVE

4	Front fixing left/right		
		Colour variants	S
		Nylon	
		ZIF.74C0	
	Incl. locking piece Z31A0008		
	Incl. 2x gallery heads ZRG.000R5F		

5	Front section		
		Colour variants	TS
		Aluminium	
		Z31L1036A	
	For cutting to size		

2	Drawer sides and cover caps left/right		
		Colour variants	TS
NL		Steel	
270 mm		378M2702SA	
300 mm		378M3002SA	
350 mm		378M3502SA	
400 mm		378M4002SA	
450 mm		378M4502SA	
500 mm		378M5002SA	
550 mm		378M5502SA	
600 mm	378M6002SA		
650 mm	378M6502SA		

6	Cross gallery		
		Colour variants	TS
		Aluminium	
		ZRG.1046Z	
	For cutting to size		

7	Longside gallery rail left/right		
		Colour variants	TS
NL		Steel	
270 mm		ZRG.207RSIC	
300 mm		ZRG.237RSIC	
350 mm		ZRG.287RSIC	
400 mm		ZRG.337RSIC	
450 mm		ZRG.387RSIC	
500 mm		ZRG.437RSIC	
550 mm		ZRG.487RSIC	
600 mm	ZRG.537RSIC		
650 mm	ZRG.587RSIC		

3	Back fixing and gallery fixing left/right		
		Colour variants	TS
		Steel	
		Z30C000S	
	Steel back	60	

Planning information

Space requirements in cabinet

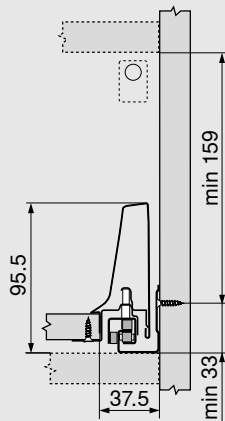

Back installation dimensions

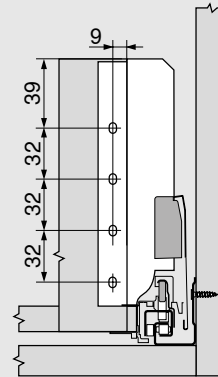

Cutting dim. for 16 mm chipboard

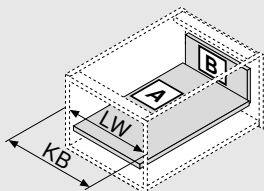

- KB Cabinet width
- LW Inner cabinet width
- NL Nominal length

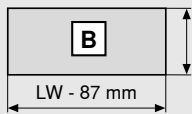

Back
167 mm

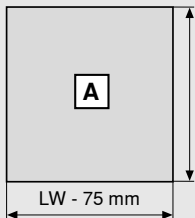

Base
Chipboard back
NL - 24 mm
Steel back
NL - 22 mm

Front piece for cutting to size

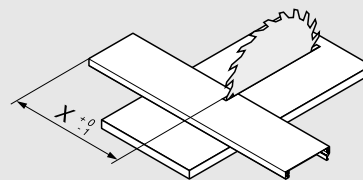

$X = LW - 132$

Cross gallery for cutting to size

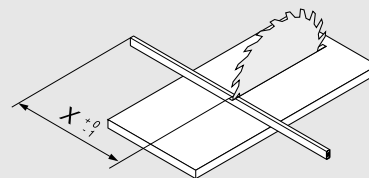

$X = LW - 122$

TANDEMBOX antaro



SPACE CORNER with SYNCROMOTION

Product



Order specification

SPACE CORNER with SYNCROMOTION – gallery – D



Colour variants	TS	R 9006	SW
	Steel		
Help with planning and ordering	www.blum.com/planningtools		

SPACE CORNER with SYNCROMOTION – gallery – C



Colour variants	TS	R 9006	SW
	Steel		
Help with planning and ordering	www.blum.com/planningtools		

SPACE CORNER with SYNCROMOTION – M

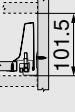

Colour variants	TS	R 9006	SW
	Steel		
Help with planning and ordering	www.blum.com/planningtools		

SPACE CORNER with rigid fronts

TANDEMBOX antaro



Product



Order specification

SPACE CORNER with Rigid fronts – gallery – D



Colour variants	TS	R 9006	SW
	Steel		
Help with planning and ordering	www.blum.com/planningtools		

SPACE CORNER with Rigid fronts – M



Colour variants	TS	R 9006	SW
	Steel		
Help with planning and ordering	www.blum.com/planningtools		

TANDEMBOX antaro



Sink pull-out – gallery – D – M drawer side

Product



Space requirement

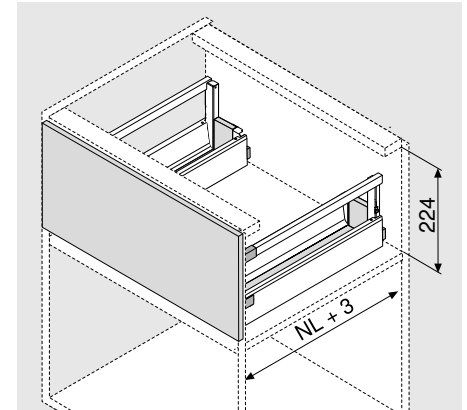
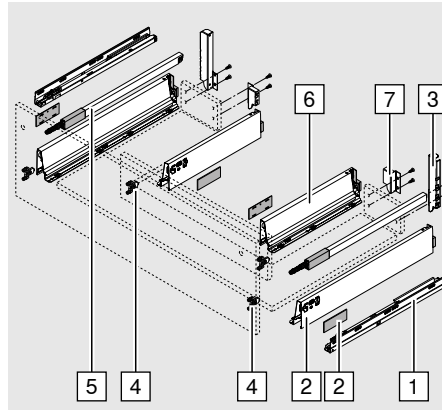

NL Nominal length

Order specification

1	Cabinet profiles left/right	
		BLUMOTION*
	NL	30 kg 65 kg
	450 mm	578.4501B
	500 mm	578.5001B
	550 mm	578.5501B
	600 mm	578.6001B 576.6001B
	650 mm	576.6501B
	* Suitable for SERVO-DRIVE	

5	Longside gallery rail left/right	
	Colour variants	TS R 9006 SW
	NL	Steel
	450 mm	ZRG.387RSIC
	500 mm	ZRG.437RSIC
	550 mm	ZRG.487RSIC
	600 mm	ZRG.537RSIC
	650 mm	ZRG.587RSIC

2	Drawer sides and cover caps left/right (outer)	
	Colour variants	TS R 9006 SW
	NL	Steel
	450 mm	378M4502SA
	500 mm	378M5002SA
	550 mm	378M5502SA
	600 mm	378M6002SA
	650 mm	378M6502SA

6	Drawer sides and cover caps left/right (inner)	
	Colour variants	TS R 9006 SW
	NL	Steel
	270 mm	378M2702SA
	300 mm	378M3002SA
	350 mm	378M3502SA
	400 mm	378M4002SA
	450 mm	378M4502SA
	500 mm	378M5002SA
Recommendation: NL external drawer side - NL internal drawer side = min. 150		

3	Back fixing left/right (outer)	
	Colour variants	TS R 9006 SW
		Steel
		2 x Z30D000S.22
	Steel back	60

7	Back fixing left/right (inner)	
	Colour variants	TS R 9006 SW
		Steel
		2 x Z30M000S.04
	Steel back	60

4	Front fixing bracket	
	INSERTA version	4 x ZSF.39A2
	Screw-on version	4 x ZSF.35A2
Knock-in version	4 x ZSF.36A2	

Planning information

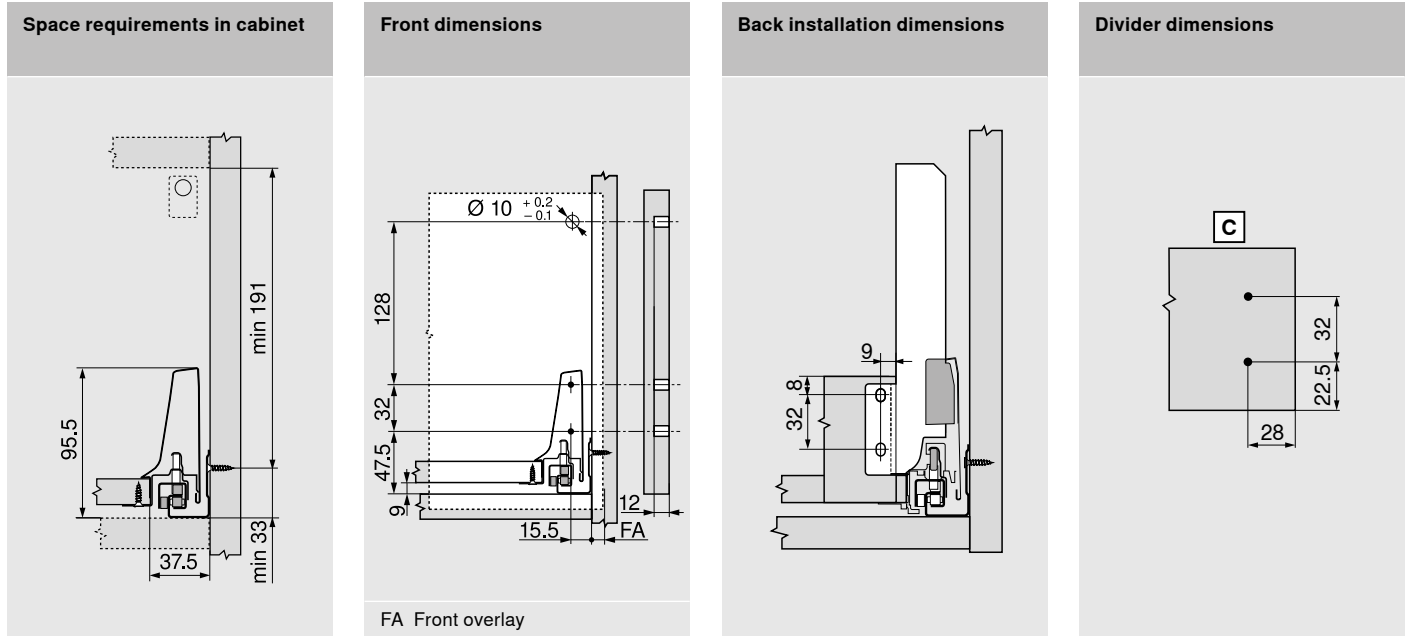

Cutting dim. for 16 mm chipboard

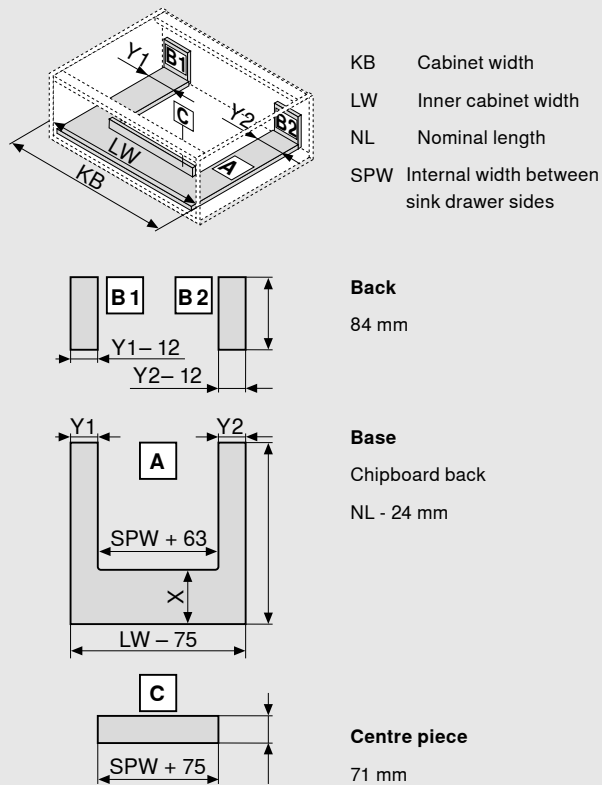

X = NL of external drawer side – NL of internal drawer side – 10

Y min. = 48 mm

Y min. = 75 mm with TIP-ON BLUMOTION

Y max. = 225 mm

TANDEMBOX antaro



Sink pull-out – gallery – C – M drawer side

Product



Space requirement

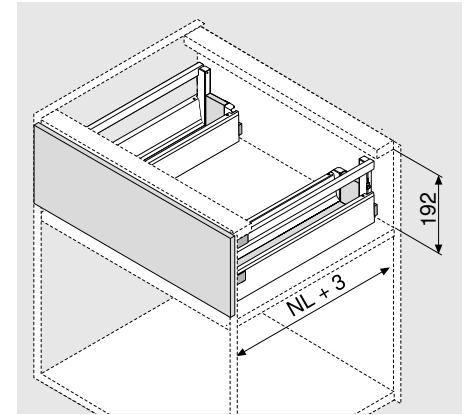
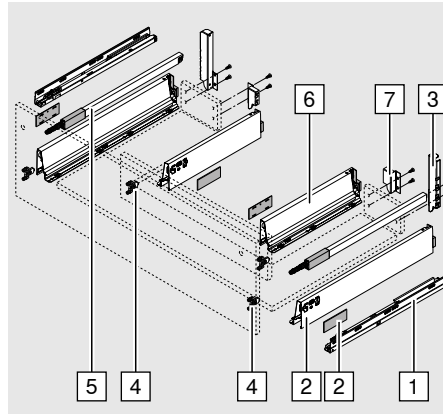

NL Nominal length

Order specification

1	Cabinet profiles left/right	
		BLUMOTION*
	NL	30 kg 65 kg
	450 mm	578.4501B
	500 mm	578.5001B
	550 mm	578.5501B
	600 mm	578.6001B 576.6001B
	650 mm	576.6501B

* Suitable for SERVO-DRIVE

5	Longside gallery rail left/right		
	Colour variants	TS	R 9006 SW
	NL		Steel
	450 mm		ZRG.387RSIC
	500 mm		ZRG.437RSIC
	550 mm		ZRG.487RSIC
	600 mm		ZRG.537RSIC
	650 mm		ZRG.587RSIC

2	Drawer sides and cover caps left/right (outer)		
	Colour variants	TS	R 9006 SW
	NL		Steel
	450 mm		378M4502SA
	500 mm		378M5002SA
	550 mm		378M5502SA
	600 mm		378M6002SA
	650 mm		378M6502SA

6	Drawer sides and cover caps left/right (inner)		
	Colour variants	TS	R 9006 SW
	NL		Steel
	270 mm		378M2702SA
	300 mm		378M3002SA
	350 mm		378M3502SA
	400 mm		378M4002SA
	450 mm		378M4502SA
500 mm		378M5002SA	
Recommendation: NL external drawer side - NL internal drawer side = min. 150			

3	Back fixing left/right (outer)		
	Colour variants	TS	R 9006 SW
			Steel
		2 x	Z30C000S.22
Steel back			60

7	Back fixing left/right (inner)		
	Colour variants	TS	R 9006 SW
			Steel
		2 x	Z30M000S.04
Steel back			60

4	Front fixing bracket		
	INSERTA version	4 x	ZSF.39A2
	Screw-on version	4 x	ZSF.35A2
Knock-in version	4 x	ZSF.36A2	

Planning information

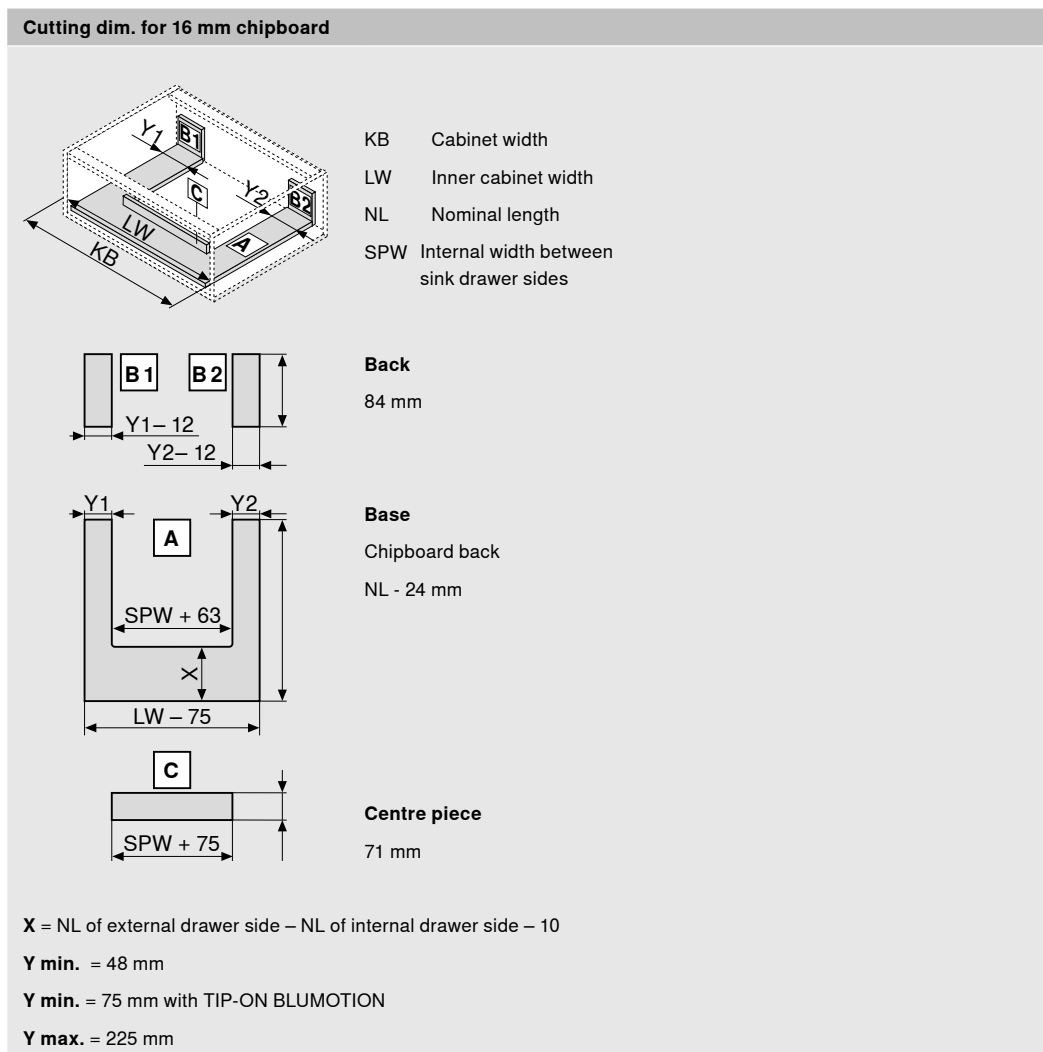
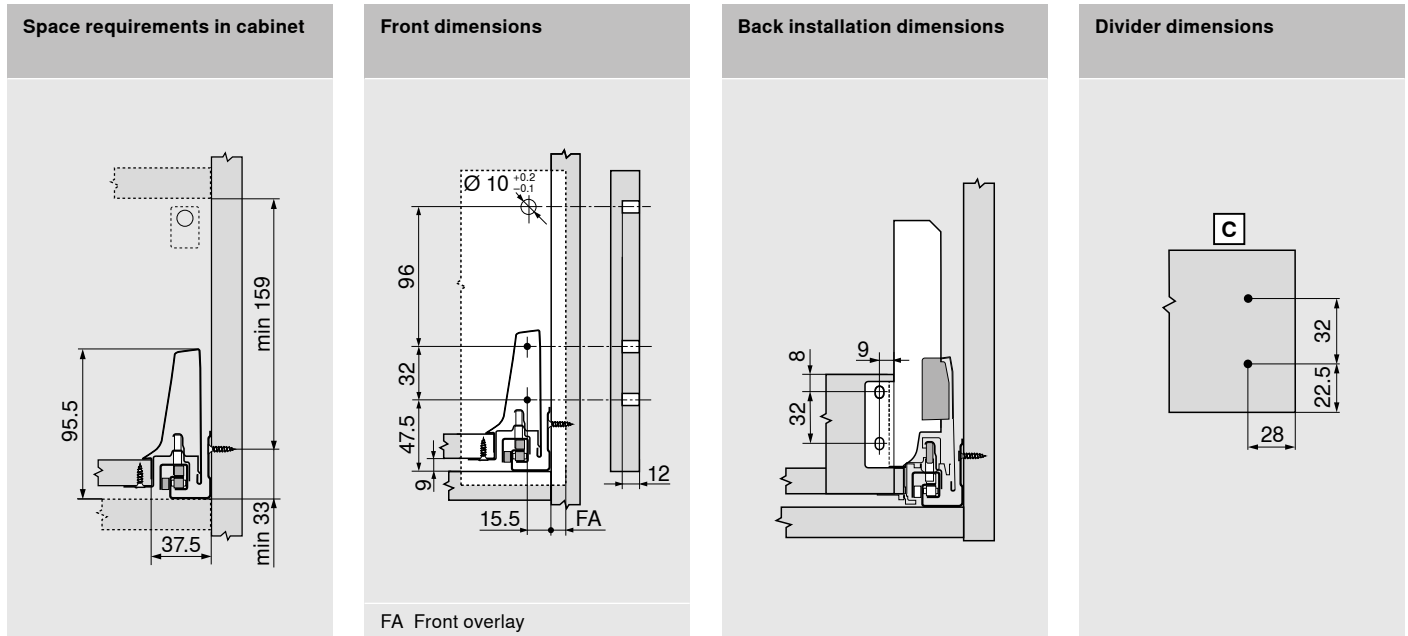

TANDEMBOX antaro



Design element – D – M drawer side



Order specification

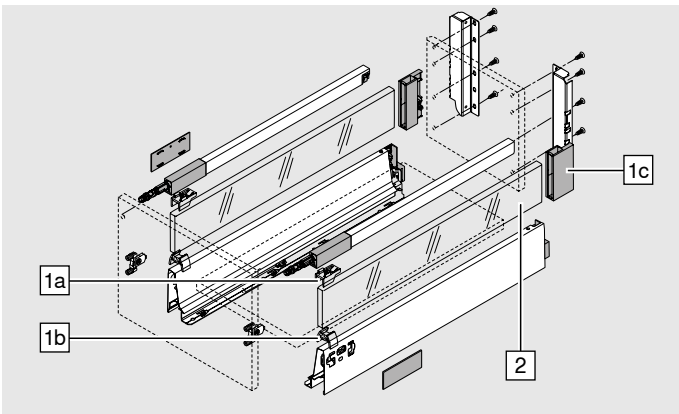

1	Locking piece set		
	Colour variants	S	WGR SW
		Nylon	
		Z36D0080	
	Includes:		
	1a 2 x locking pieces front upper (transparent)		
	1b 2 x locking pieces front lower (transparent)		
	1c 1 x locking piece left/right		

2	Design element		
	Colour variants	Clear	Frosted
	NL	Glass	
	270 mm	Z37R237D	
	300 mm	Z37R267D	
	350 mm	Z37R317D	
	400 mm	Z37R367D	
	450 mm	Z37R417D	
	500 mm	Z37R467D	
	550 mm	Z37R517D	
	600 mm	Z37R567D	
650 mm	Z37R617D		
Consisting of: 2 pieces			

2	Metal design element (can be cut down to suit smaller NL)			
	Colour variants	TS	R 9006	SW
	NL	Aluminium		
	270 mm	2 x	= 237 mm	
	300 mm	2 x	= 267 mm	
	350 mm	2 x	= 317 mm	
	400 mm	2 x	= 367 mm	
	450 mm	2 x	Z37A417D	
	500 mm	2 x	Z37A467D	
	550 mm	2 x	Z37A517D	
	600 mm	2 x	= 567 mm	
650 mm	2 x	Z37A617D		

Design element cutting dimensions

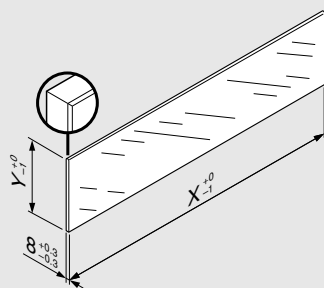

In combination with TANDEMBOX antaro no impact test for vertical glass components is stipulated due to the dimensions given, see standard (DIN EN 14749 release Nov. 2005).

Safety glass is not required in order to comply with the standard.



Order specification

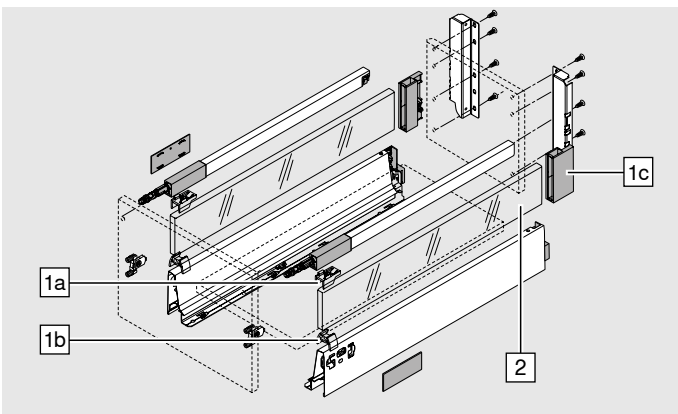

	1 Locking piece set		
	Colour variants	S	WGR SW
		Nylon	
		Z36C0080	
Includes:			
1a 2 x locking pieces front upper (transparent)			
1b 2 x locking pieces front lower (transparent)			
1c 1 x locking piece left/right			

	2 Design element		
	Colour variants	Clear	Frosted
	NL	Glass	
	270 mm	Z37R237C	
	300 mm	Z37R267C	
	350 mm	Z37R317C	
	400 mm	Z37R367C	
	450 mm	Z37R417C	
	500 mm	Z37R467C	
	550 mm	Z37R517C	
	600 mm	Z37R567C	
650 mm	Z37R617C		
Consisting of: 2 pieces			

	2 Metal design element (can be cut down to suit smaller NL)		
	Colour variants	TS	R 9006 SW
	NL	Aluminium	
	270 mm	2 x	= 237 mm
	300 mm	2 x	= 267 mm
	350 mm	2 x	= 317 mm
	400 mm	2 x	= 367 mm
	450 mm	2 x	Z37A417C
	500 mm	2 x	Z37A467C
	550 mm	2 x	Z37A517C
	600 mm	2 x	= 567 mm
650 mm	2 x	Z37A617C	

Design element cutting dimensions

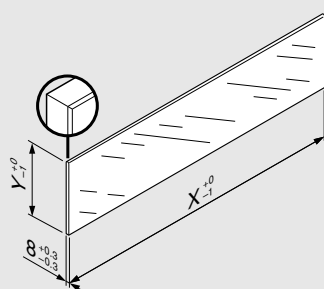

Y = 59.5
X = NL - 33

In combination with TANDEMBOX antaro no impact test for vertical glass components is stipulated due to the dimensions given, see standard (DIN EN 14749 release Nov. 2005).

Safety glass is not required in order to comply with the standard.

TANDEMBOX antaro



Drawer – K

Product

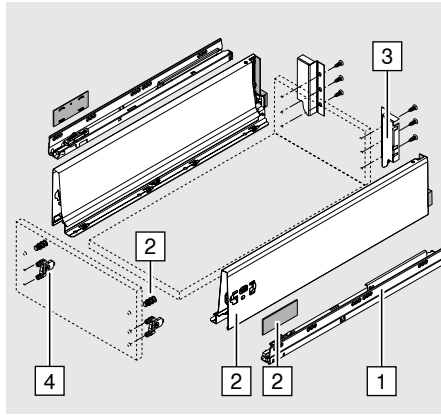

Space requirement

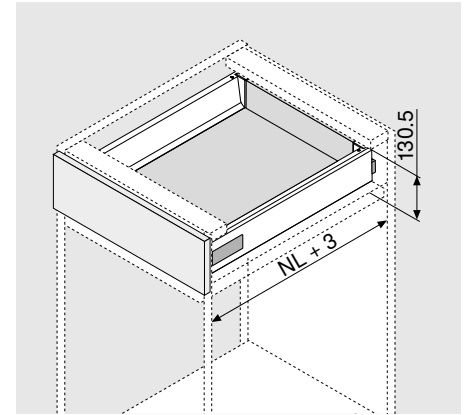

NL Nominal length

Order specification

1	Cabinet profiles left/right		
		BLUMOTION*	
	NL	30 kg	65 kg
	270 mm	578.2701B	
	300 mm	578.3001B	
	350 mm	578.3501B	
	400 mm	578.4001B	
	450 mm	578.4501B	576.4501B
	500 mm	578.5001B	576.5001B
	550 mm	578.5501B	576.5501B
	600 mm	578.6001B	576.6001B
	650 mm		576.6501B
* Suitable for SERVO-DRIVE			

3	Back fixing and gallery fixing left/right		
	Colour variants	TS	R 9006
		Steel	
		Z30K000S	
Steel back			60

4	Front fixing bracket		
	INSERTA version	2 x	ZSF.39A2
Screw-on version	2 x	ZSF.35A2	
Knock-in version	2 x	ZSF.36A2	

2	Drawer sides and cover caps left/right		
	Colour variants	TS	R 9006
NL		Steel	
270 mm		378K2702SA	
300 mm		378K3002SA	
350 mm		378K3502SA	
400 mm		378K4002SA	
450 mm		378K4502SA	
500 mm		378K5002SA	
550 mm		378K5502SA	
600 mm		378K6002SA	
650 mm		378K6502SA	

Planning information

Space requirements in cabinet

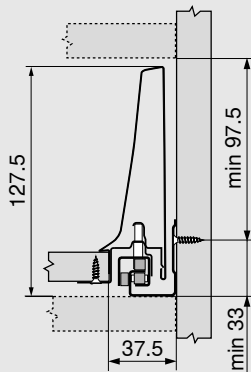

Front dimensions

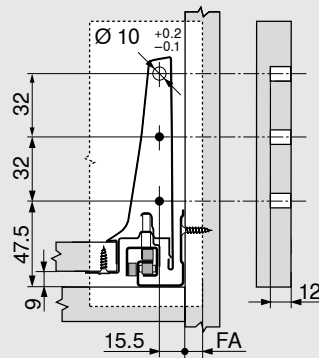

FA Front overlay

Back installation dimensions

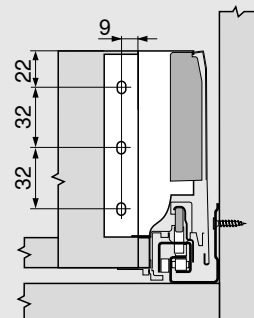

Cutting dim. for 16 mm chipboard

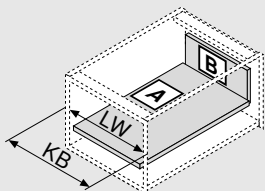

- KB Cabinet width
- LW Inner cabinet width
- NL Nominal length

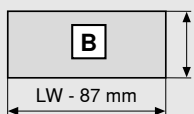

Back
116 mm

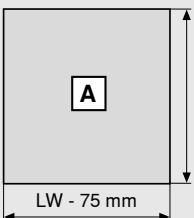

Base
Chipboard back
NL - 24 mm
Steel back
NL - 22 mm

TANDEMBOX antaro



Drawer – M

Product

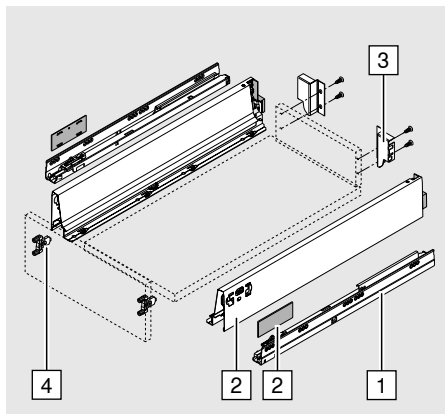

Space requirement

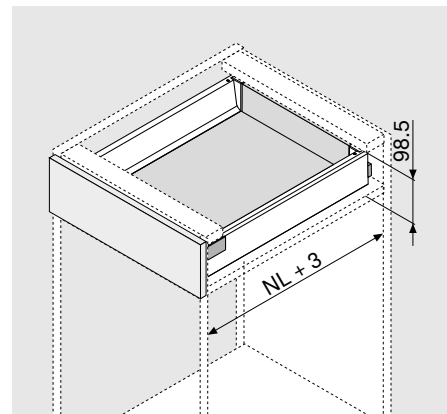

NL Nominal length

Order specification

1	Cabinet profiles left/right		
		BLUMOTION*	
	NL	30 kg	65 kg
	270 mm	578.2701B	
	300 mm	578.3001B	
	350 mm	578.3501B	
	400 mm	578.4001B	
	450 mm	578.4501B	576.4501B
	500 mm	578.5001B	576.5001B
	550 mm	578.5501B	576.5501B
	600 mm	578.6001B	576.6001B
	650 mm		576.6501B
* Suitable for SERVO-DRIVE			

3	Back fixing and gallery fixing left/right		
	Colour variants	TS	R 9006 SW
		Steel	
		Z30M000S.04	
	Steel back		60

4	Front fixing bracket		
	INSERTA version	2 x	ZSF.39A2
	Screw-on version	2 x	ZSF.35A2
	Knock-in version	2 x	ZSF.36A2

2	Drawer sides and cover caps left/right		
	Colour variants	TS	R 9006 SW
	NL	Steel	
	270 mm	378M2702SA	
	300 mm	378M3002SA	
	350 mm	378M3502SA	
	400 mm	378M4002SA	
	450 mm	378M4502SA	
	500 mm	378M5002SA	
	550 mm	378M5502SA	
	600 mm	378M6002SA	
	650 mm	378M6502SA	

Planning information

Space requirements in cabinet

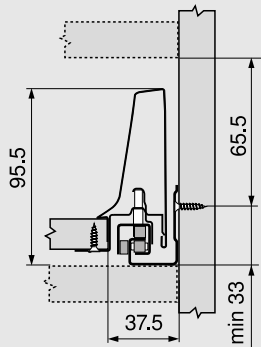

Front dimensions

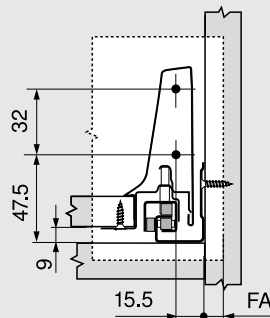

FA Front overlay

Back installation dimensions

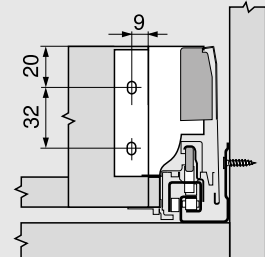

Cutting dim. for 16 mm chipboard

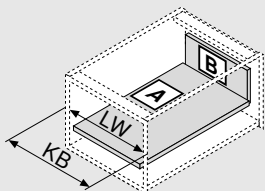

- KB Cabinet width
- LW Inner cabinet width
- NL Nominal length

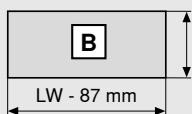

Back
84 mm

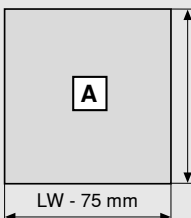

Base
Chipboard back
NL - 24 mm
Steel back
NL - 22 mm

TANDEMBOX antaro



Drawer – N

Product

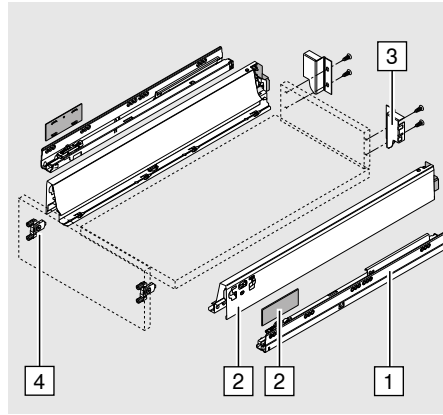

Space requirement

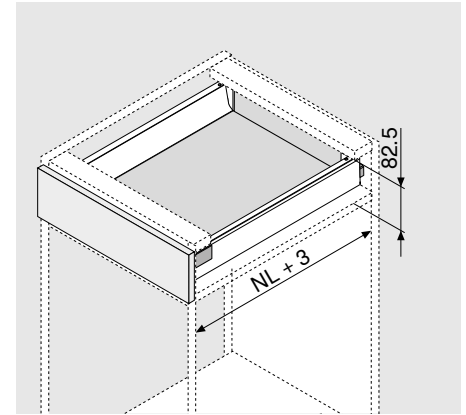

NL Nominal length

Order specification

1	Cabinet profiles left/right		
		BLUMOTION*	
	NL	30 kg	65 kg
	400 mm	578.4001B	
	450 mm	578.4501B	576.4501B
	500 mm	578.5001B	576.5001B
	550 mm	578.5501B	576.5501B
* Suitable for SERVO-DRIVE			

2	Drawer sides and cover caps left/right		
	Colour variants	TS	R 9006 SW
	NL		Steel
	400 mm		378N4002SA
	450 mm		378N4502SA
	500 mm		378N5002SA
	550 mm		378N5502SA

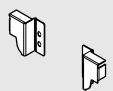
3	Back fixing and gallery fixing left/right		
	Colour variants	TS	R 9006 SW
			Steel
			Z30N000S.04
	Steel back		60

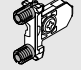
4	Front fixing bracket		
	INSERTA version	2 x	ZSF.39A2
	Screw-on version	2 x	ZSF.35A2
	Knock-in version	2 x	ZSF.36A2

Planning information

Space requirements in cabinet

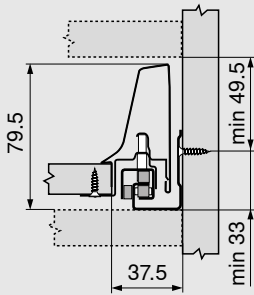

Front dimensions

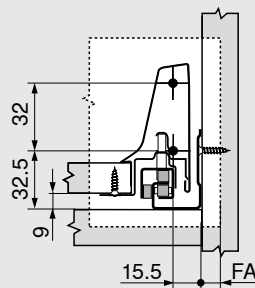

FA Front overlay

Back installation dimensions

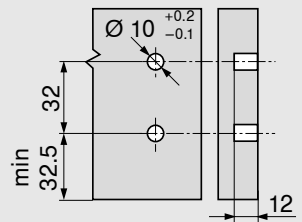

Cutting dim. for 16 mm chipboard

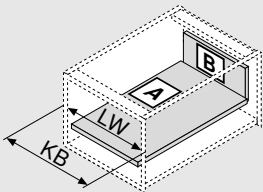

- KB Cabinet width
- LW Inner cabinet width
- NL Nominal length

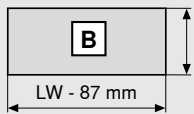

Back
69 mm

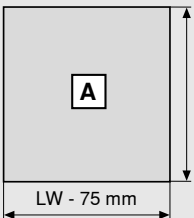

Base
Chipboard back
NL - 24 mm
Steel back
NL - 22 mm

TANDEMBOX antaro



Inner drawer – K

Product



Space requirement

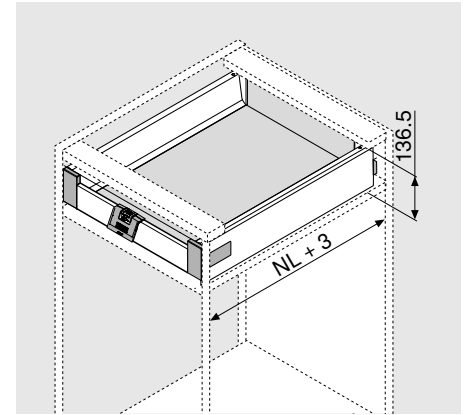
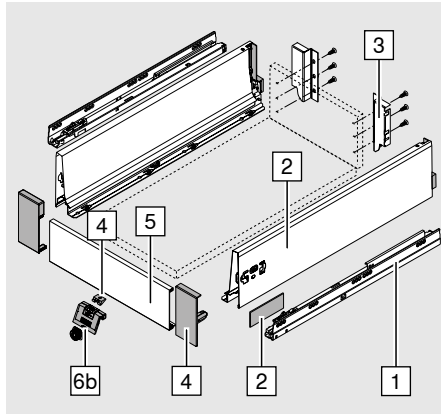

NL Nominal length

Order specification

1	Cabinet profiles left/right		
		BLUMOTION*	
	NL	30 kg	65 kg
	270 mm	578.2701B	
	300 mm	578.3001B	
	350 mm	578.3501B	
	400 mm	578.4001B	
	450 mm	578.4501B	576.4501B
	500 mm	578.5001B	576.5001B
	550 mm	578.5501B	576.5501B
	600 mm	578.6001B	576.6001B
	650 mm		576.6501B
* Suitable for SERVO-DRIVE			

2	Drawer sides and cover caps left/right		
	Colour variants	TS	R 9006 SW
	NL		Steel
	270 mm	378K2702SA	
	300 mm	378K3002SA	
	350 mm	378K3502SA	
	400 mm	378K4002SA	
	450 mm	378K4502SA	
	500 mm	378K5002SA	
	550 mm	378K5502SA	
	600 mm	378K6002SA	
650 mm	378K6502SA		

3	Back fixing and gallery fixing left/right		
	Colour variants	TS	R 9006 SW
			Steel
		Z30K000S	
Steel back			60

4	Front fixing left/right		
	Colour variants	S	WGR SW
			Nylon
		ZIF.74D0	
Incl. locking piece Z31A0008			

5	Front section		
	Colour variants	TS	R 9006 SW
			Aluminium
		Z31L1036A	
For cutting to size			

6a	Handle		
	Colour variants	S	WGR SW
			Nylon
		ZIF.80M5	

Alternative to 6a

6b	Handle and latch (optional)		
	Colour variants	S	WGR SW
			Nylon
		ZIF.80M7	

Planning information

Space requirements in cabinet

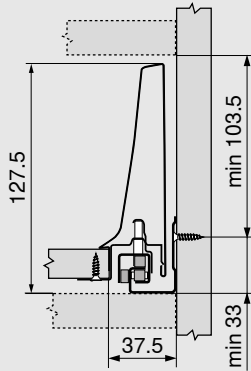

Front drilling distance for latch

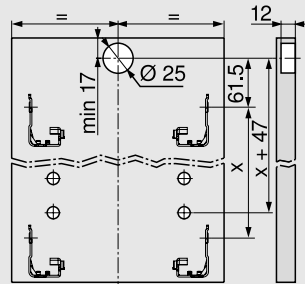

Back installation dimensions

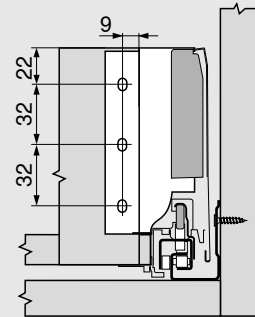

Cutting dim. for 16 mm chipboard

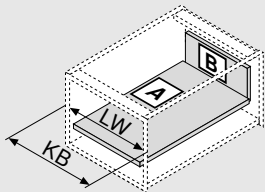

- KB Cabinet width
- LW Inner cabinet width
- NL Nominal length

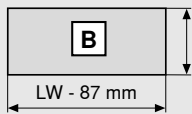

- Back**
- 116 mm

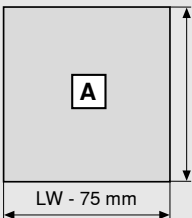

- Base**
- Chipboard back
- NL - 24 mm
- Steel back
- NL - 22 mm

Front piece for cutting to size

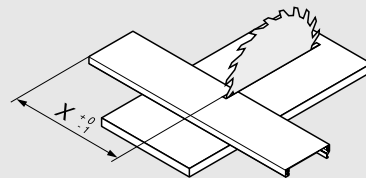

$X = LW - 132$

TANDEMBOX antaro



Inner drawer – M

Product



Space requirement

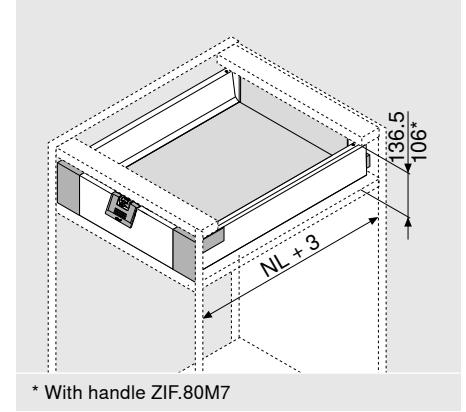
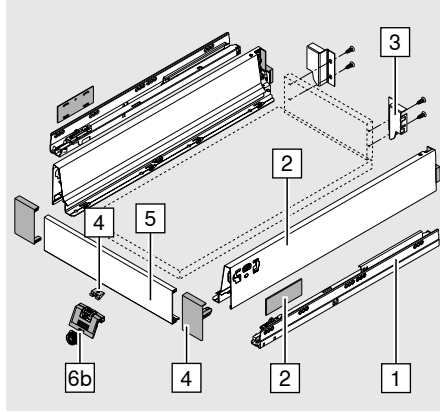

* With handle ZIF.80M7

NL Nominal length

Order specification

1	Cabinet profiles left/right		
		BLUMOTION*	
	NL	30 kg	65 kg
	270 mm	578.2701B	
	300 mm	578.3001B	
	350 mm	578.3501B	
	400 mm	578.4001B	
	450 mm	578.4501B	576.4501B
	500 mm	578.5001B	576.5001B
	550 mm	578.5501B	576.5501B
	600 mm	578.6001B	576.6001B
	650 mm		576.6501B

* Suitable for SERVO-DRIVE

2	Drawer sides and cover caps left/right			
	Colour variants	TS	R 9006	SW
NL		Steel		
270 mm		378M2702SA		
300 mm		378M3002SA		
350 mm		378M3502SA		
400 mm		378M4002SA		
450 mm		378M4502SA		
500 mm		378M5002SA		
550 mm		378M5502SA		
600 mm		378M6002SA		
650 mm		378M6502SA		

3	Back fixing and gallery fixing left/right			
	Colour variants	TS	R 9006	SW
		Steel		
		Z30M000S.04		
Steel back			60	

4	Front fixing left/right			
	Colour variants	S	WGR	SW
		Nylon		
		ZIF.71M0		
	Incl. locking piece Z31A0008			

5	Front section			
	Colour variants	TS	R 9006	SW
		Aluminium		
		Z31L1036A		
	For cutting to size			

6a	Handle			
	Colour variants	S	WGR	SW
		Nylon		
		ZIF.80M5		

Alternative to 6a

6b	Handle and latch (optional)			
	Colour variants	S	WGR	SW
		Nylon		
		ZIF.80M7		

Planning information

Space requirements in cabinet

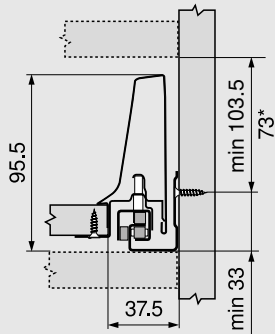

* With ZIF.80M7 can be used with height 73 and higher

Front drilling distance for latch

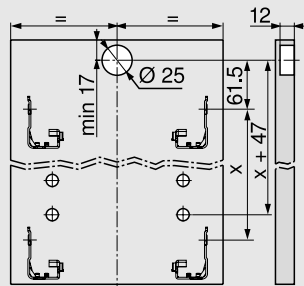

Back installation dimensions

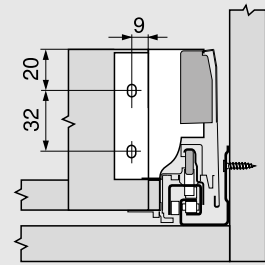

Cutting dim. for 16 mm chipboard

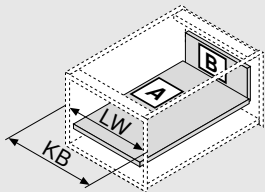

- KB Cabinet width
- LW Inner cabinet width
- NL Nominal length

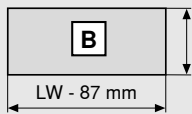

Back
84 mm

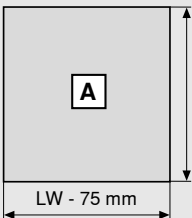

Base
Chipboard back
NL - 24 mm
Steel back
NL - 22 mm

Front piece for cutting to size

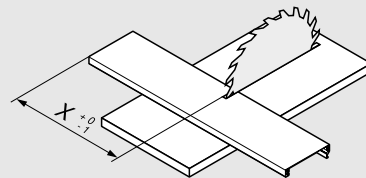

$X = LW - 132$

TANDEMBOX antaro



Accessories

Front/base stabiliser

Order specification

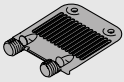

For stabilising wide and high fronts
Reinforces the connection between the drawer side and the front

Z96.10E1

Planning information

Space requirements in cabinet

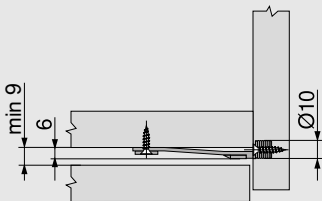

Front dimensions

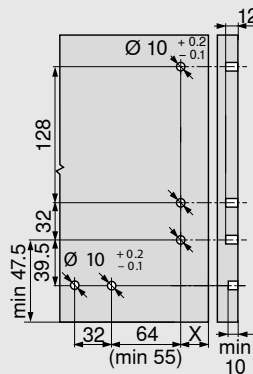

Steel back

Order specification

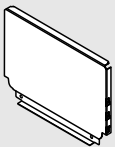

Colour variants	TS	R 9006	SW
	Steel		
N back	☎ Z30NxxxS.6		
M back	☎ Z30MxxxS.6		
K drawer back	☎ Z30KxxxS.6		
C drawer back	☎ Z30CxxxS.6		
D back	☎ Z30DxxxS.6		

Planning information

Calculation of width

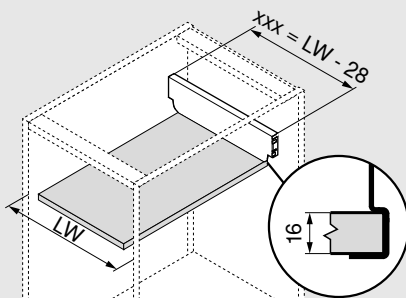

xxx Width

Example:

LW 567 mm - 28 mm = back width 539 mm

Order: **Z30M539S.6** in white

Cutting dim. for 16 mm chipboard

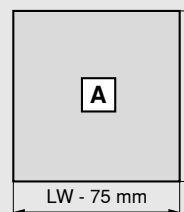

Base

NL - 22 mm

LW Inner cabinet width

NL Nominal length

Back and gallery fixing – B – M drawer side

Order specification

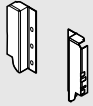

Colour variants

TS R 9006 SW

Steel

Z30B000S.04

Planning information

Space requirements in cabinet

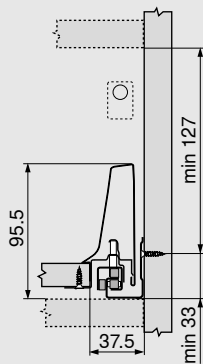

Front dimensions

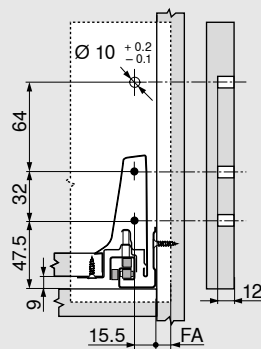

FA Front overlay

Back installation dimensions

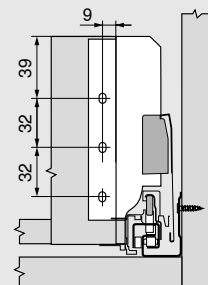

TANDEMBOX antaro



Accessories

Flexible gallery fixing

Order specification

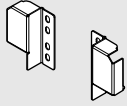

Colour variants

TS R 9006 SW

Steel

ZRR.5200

Planning information

Space requirements in cabinet

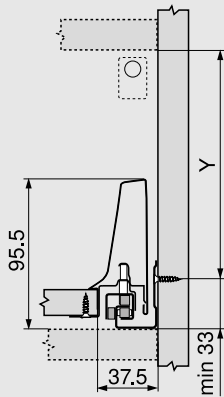

Free placement
 $Y = X - 4 \text{ mm}$
 X Back height

Front dimensions

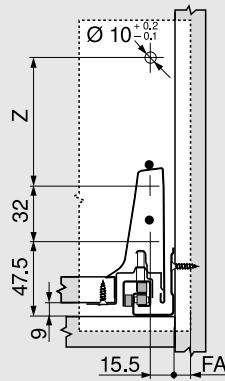

Free placement
 $Z = X - 71 \text{ mm}$
 X Back height
 FA Front overlay

Back installation dimensions

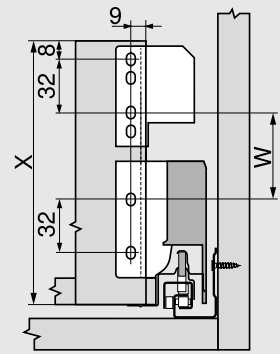

Free placement
 $W = X - 103 \text{ mm}$
 X Back height

Space requirements in cabinet

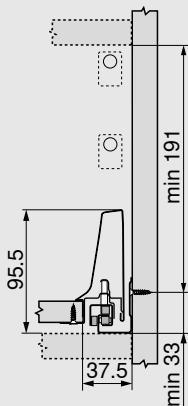

Height D – double gallery
 (back fixing bracket height B)

Front dimensions

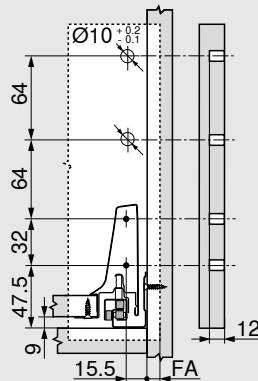

Height D – double gallery
 (back fixing bracket height B)
 FA Front overlay

Back installation dimensions

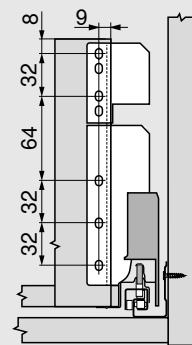

Height D – double gallery
 (back fixing bracket height B)

Cabinet profile 578 – 30 kg

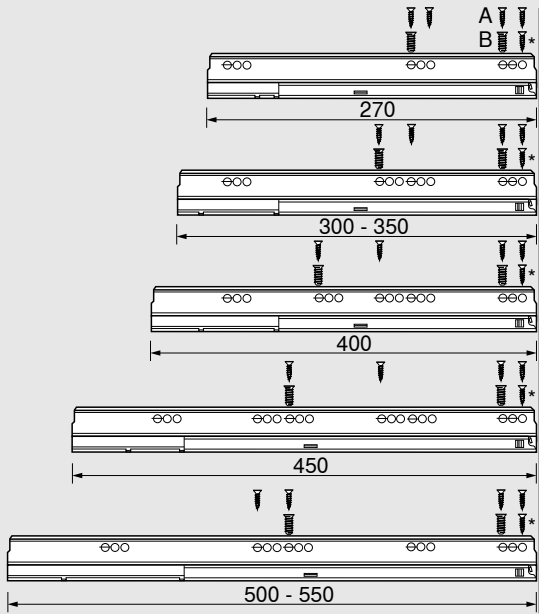

* Optional

Cabinet profile 576 – 65 kg

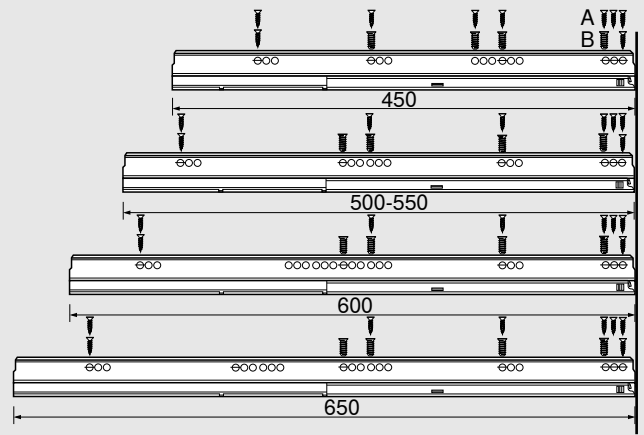

- A Chipboard screw $\varnothing 4 \times 15$ mm
- B System screw Part no. 661.145

High fronted pull-out

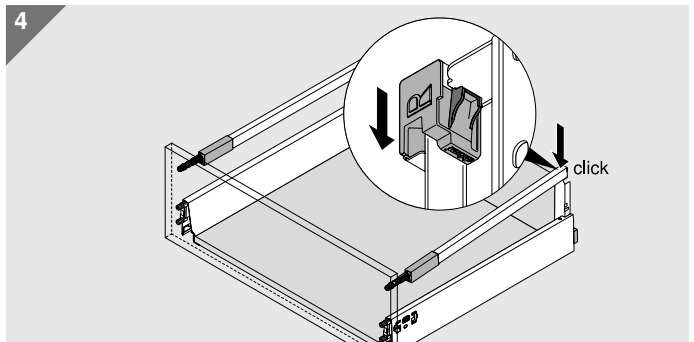
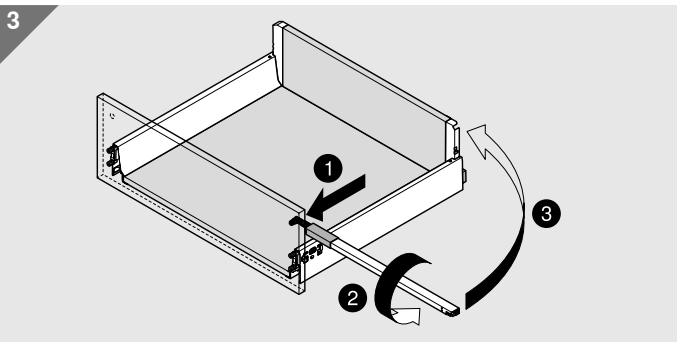
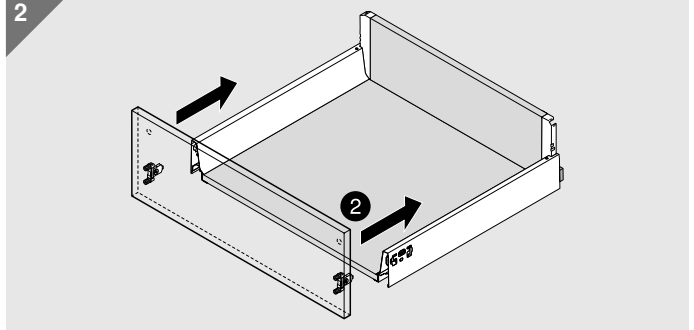
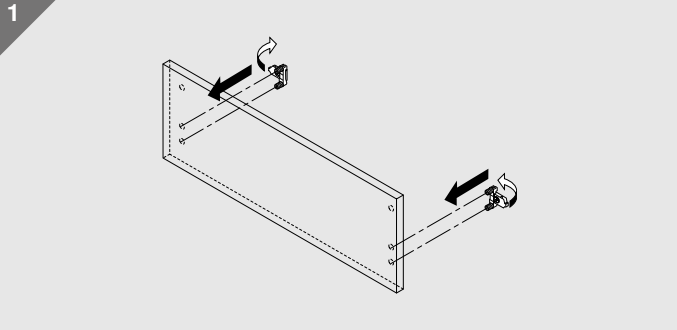

Tilt adjustment

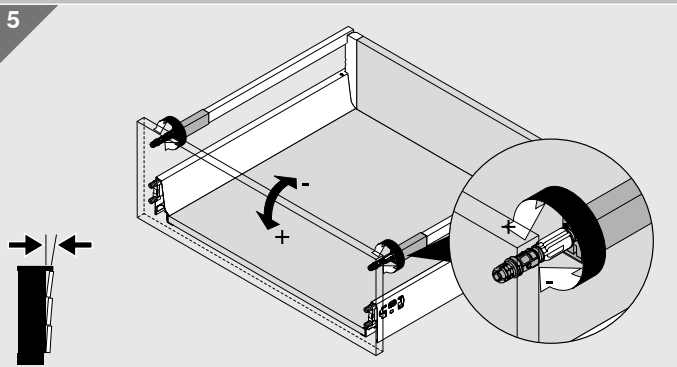

Comment: If a gallery rod is adjusted, the same adjustment must be made on all remaining rods

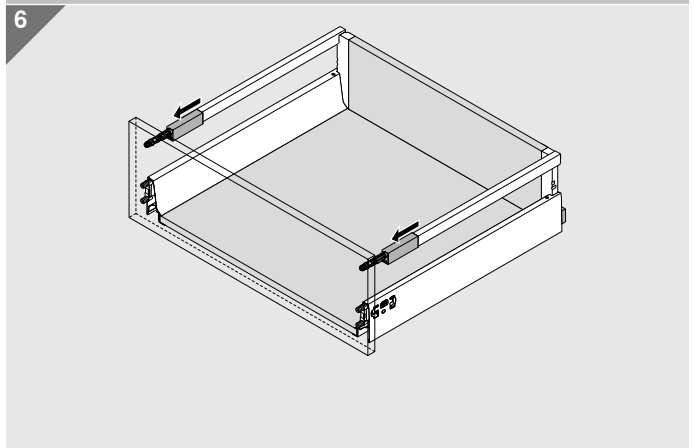

Height adjustment + side adjustment

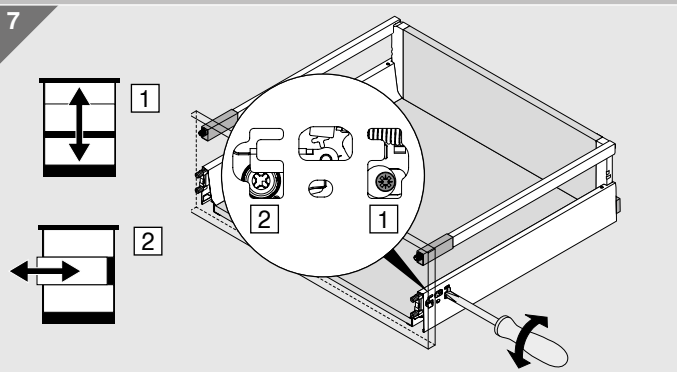

Comment: Both sides require adjustment

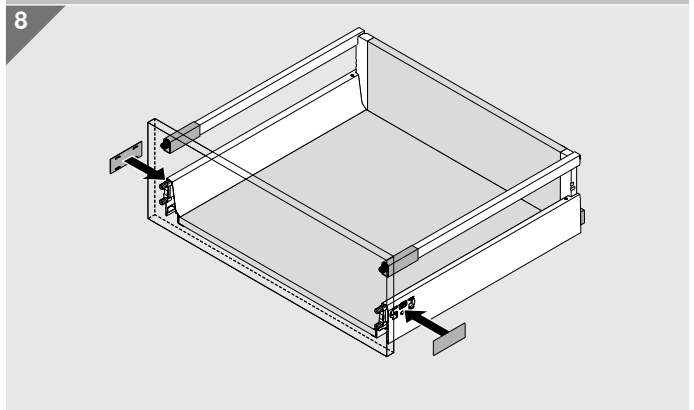

Design element

1

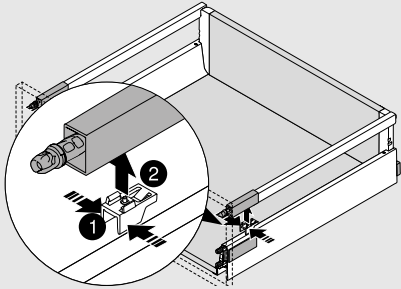

2

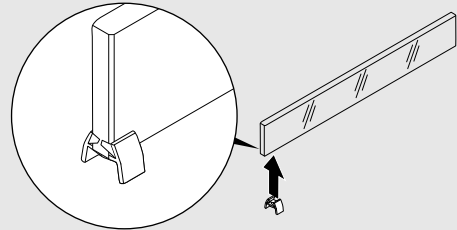

3

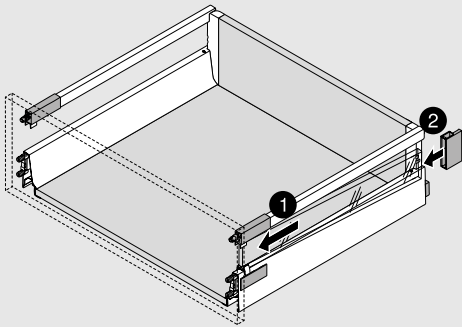

4

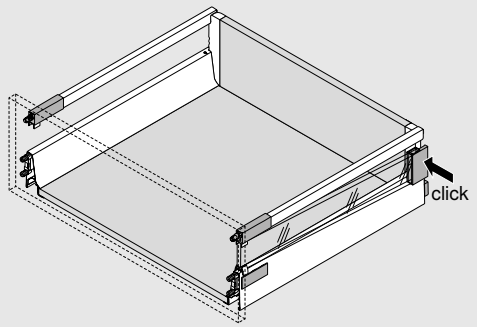

Inner pull-out

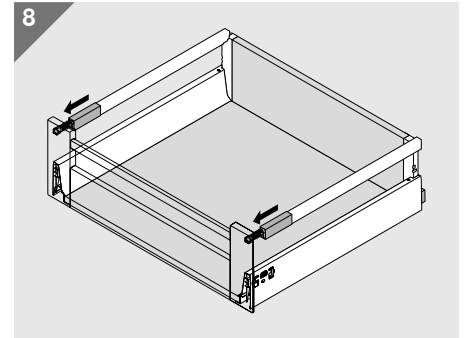
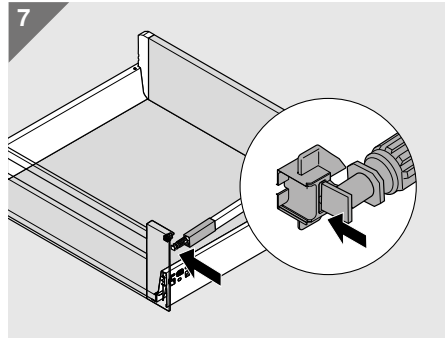
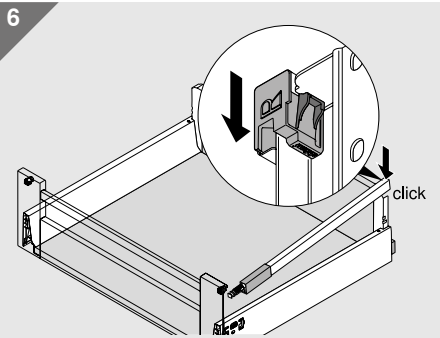
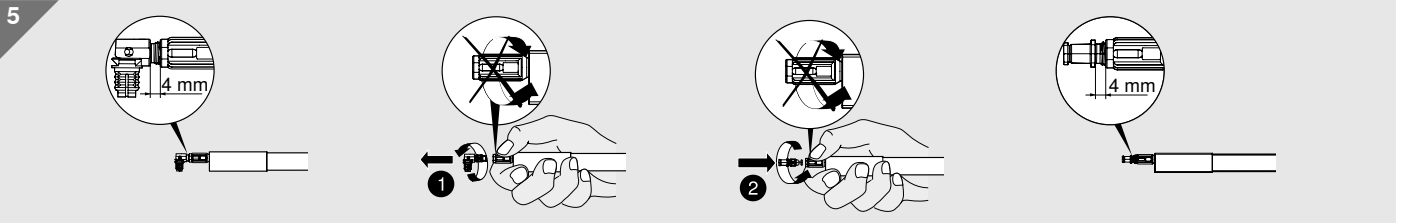
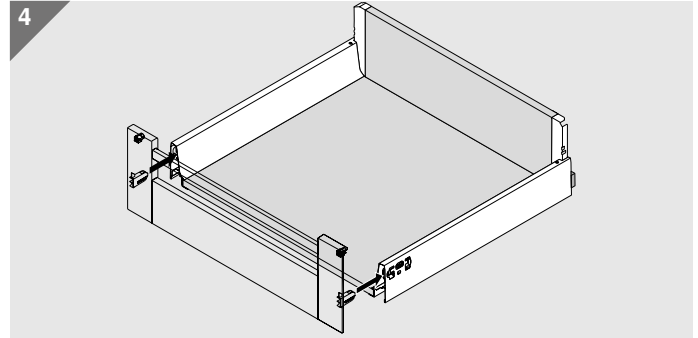
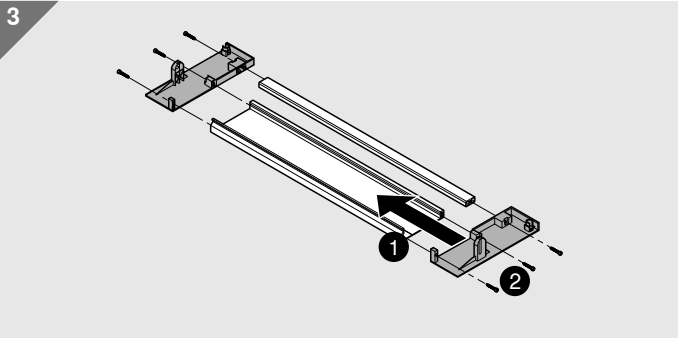
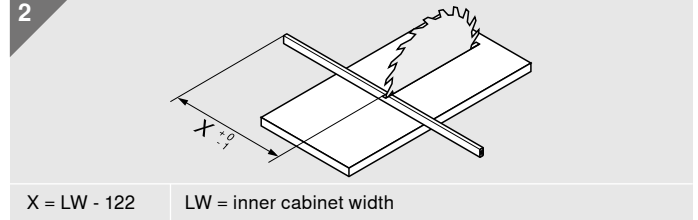
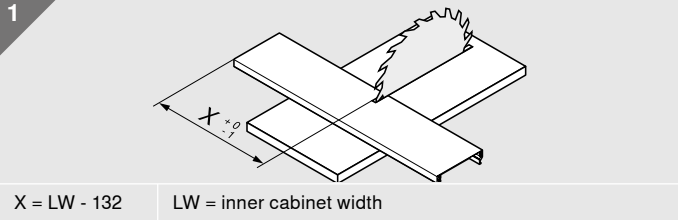

Locking piece

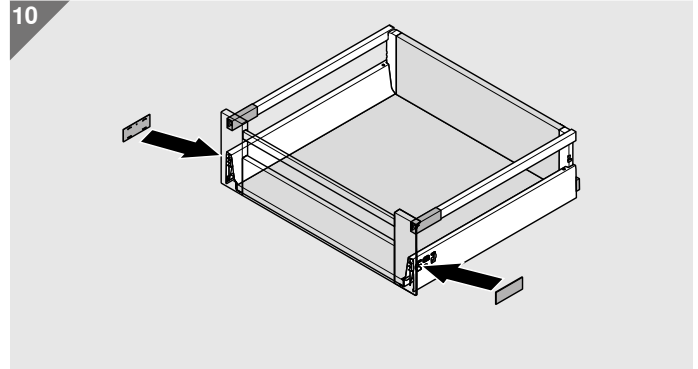
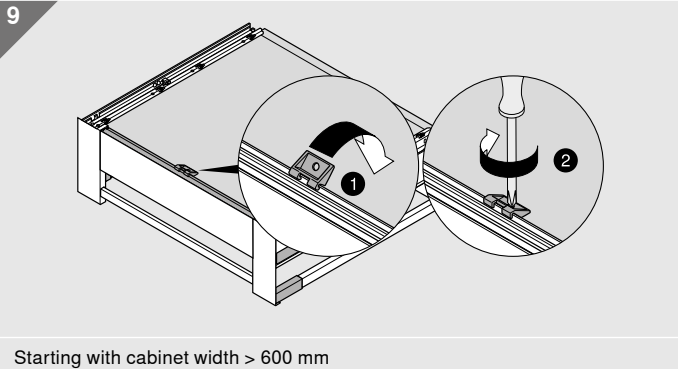

Alu frame

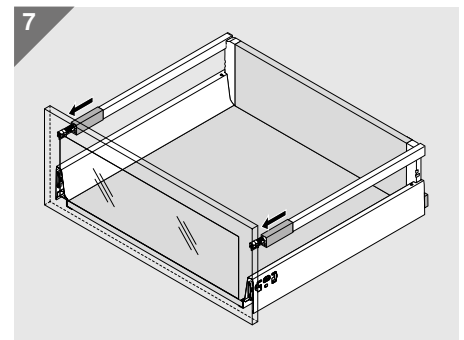
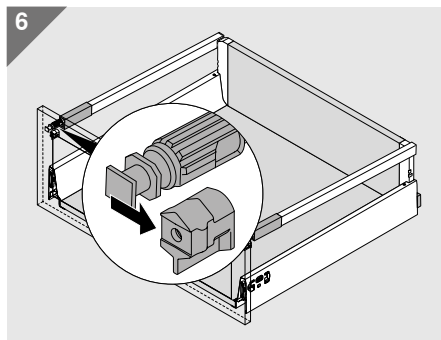
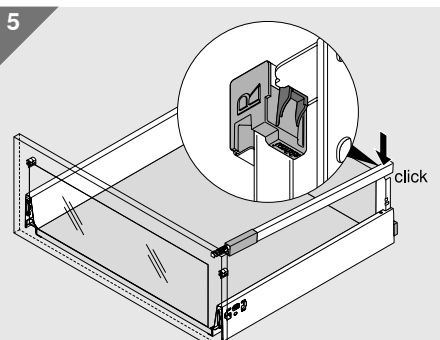
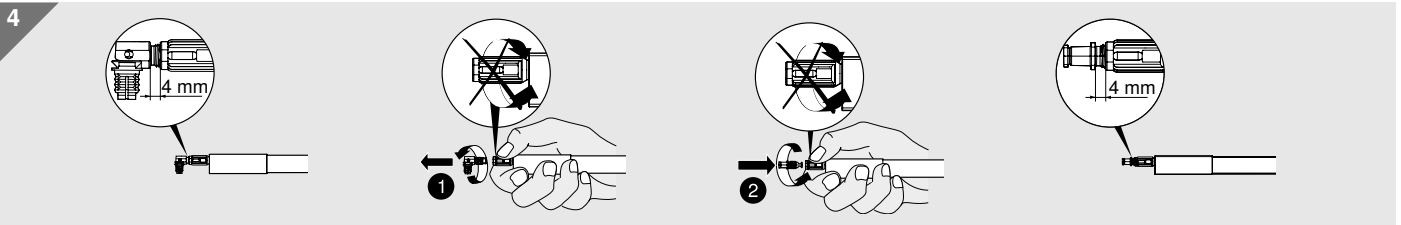
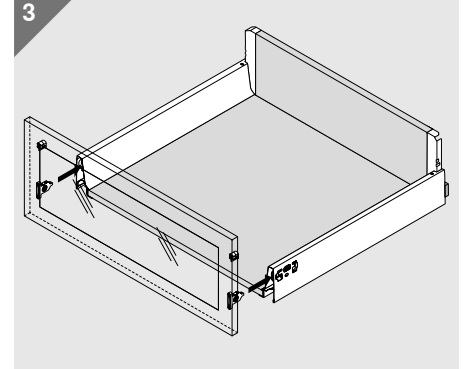
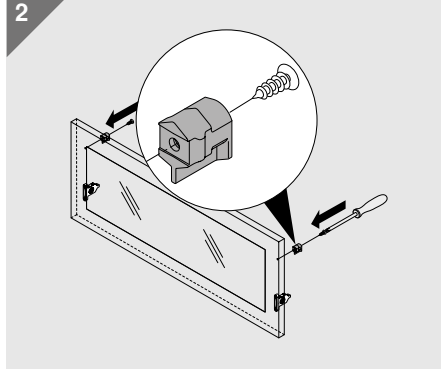
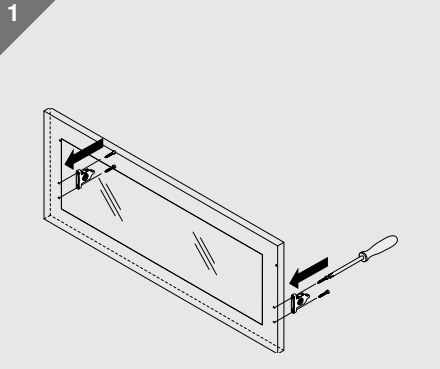

Sink pull-out

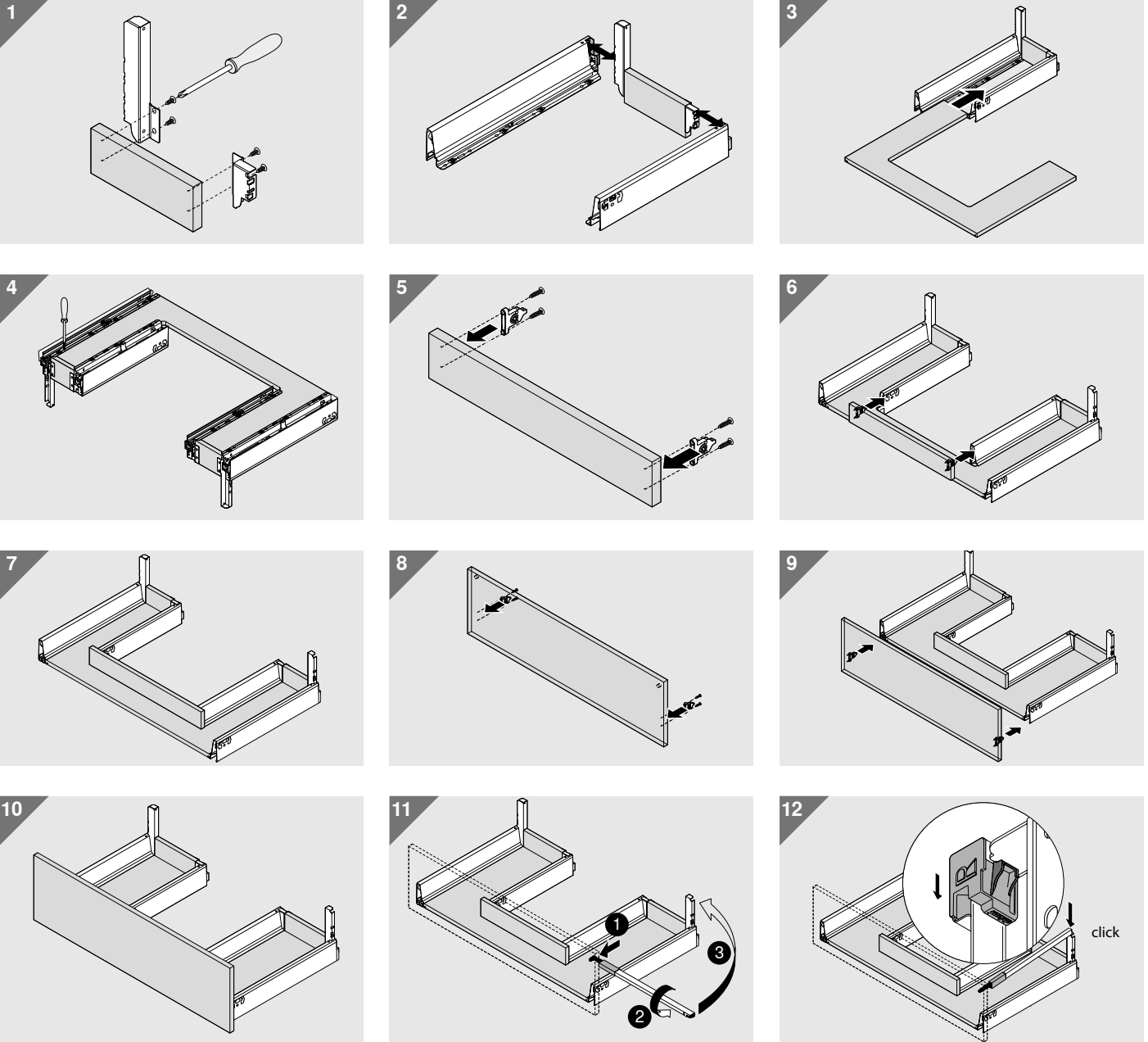

Design element removal

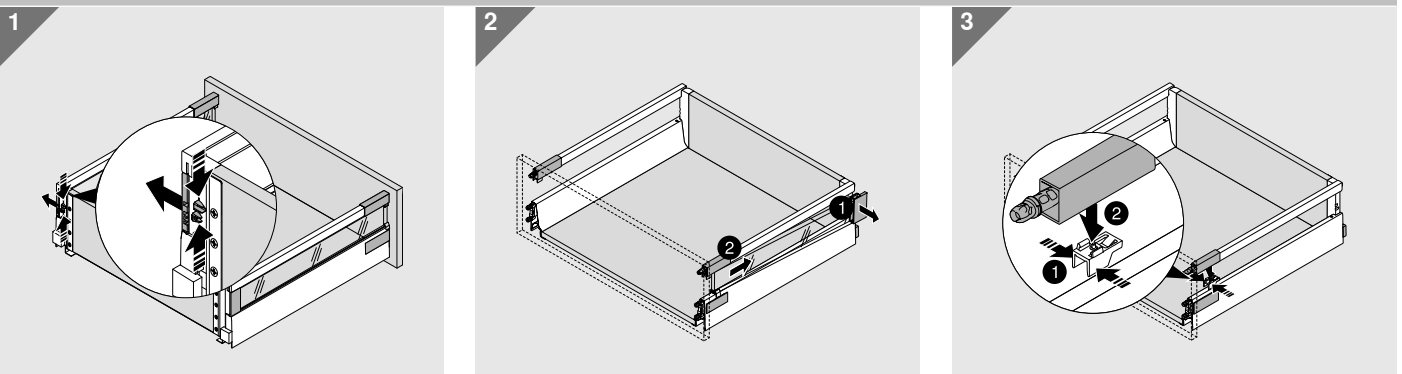

Gallery removal – high fronted pull-out

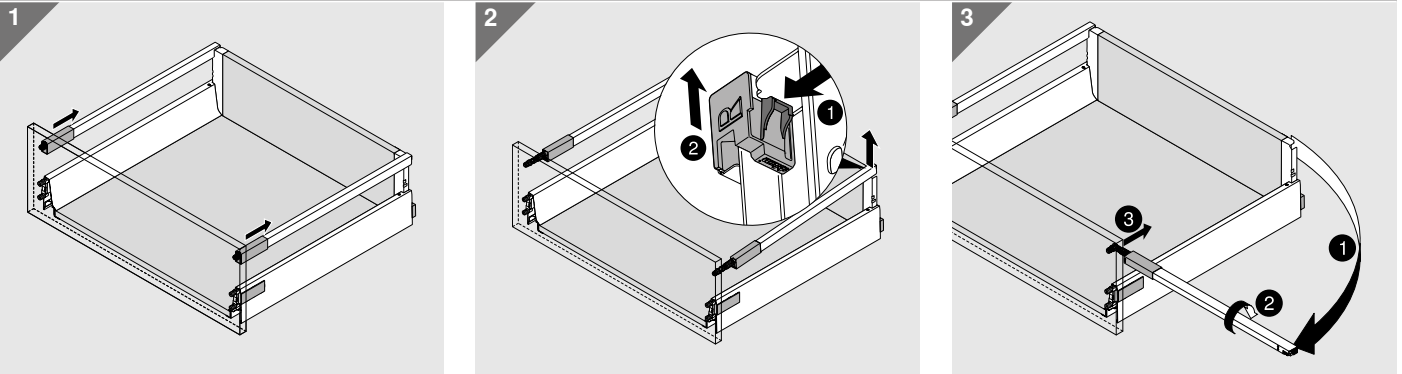

Front removal

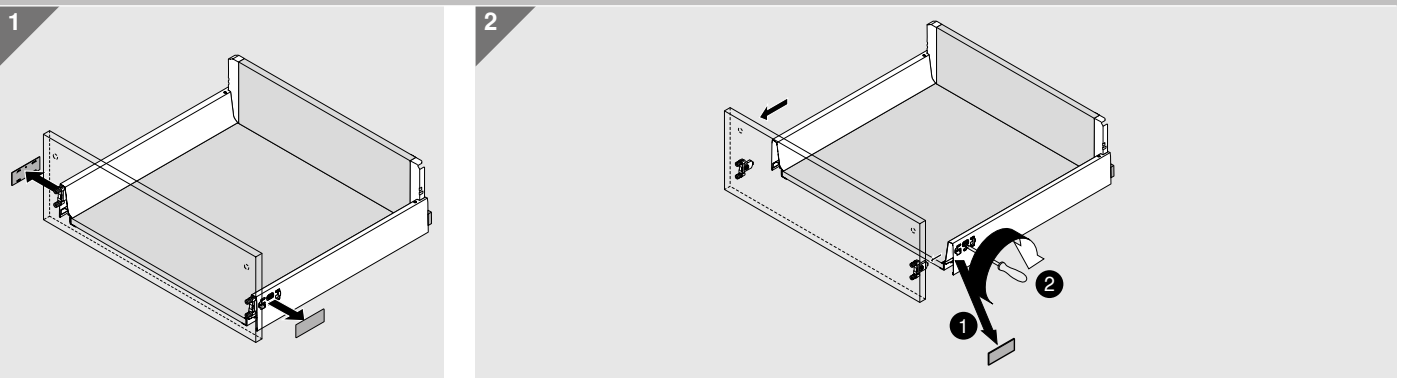

Gallery removal – inner pull-out

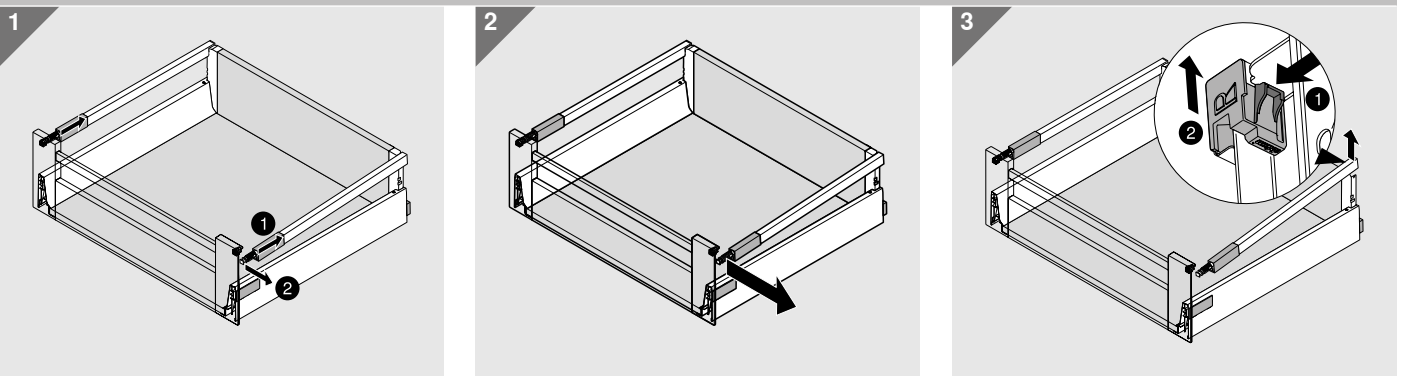

Gallery removal – alu frame

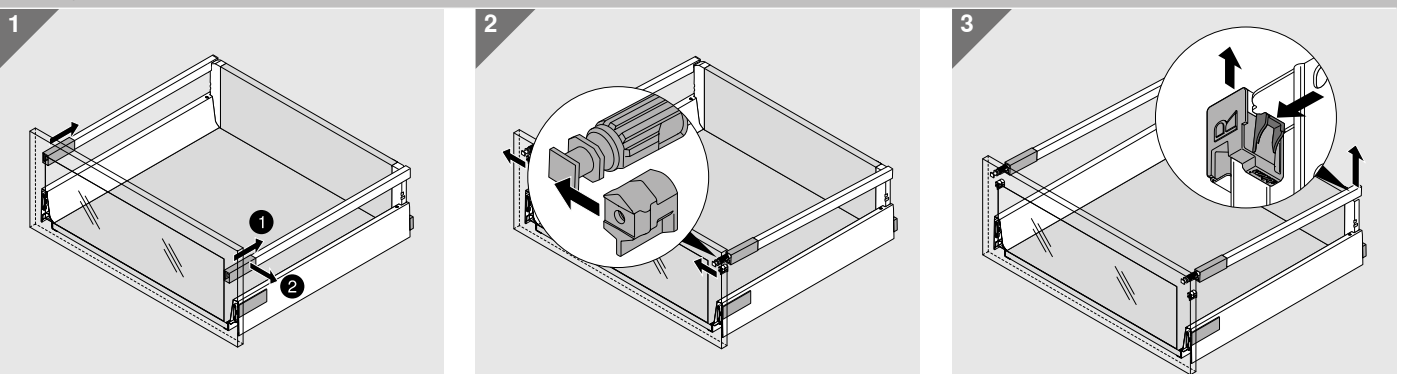

Drawer

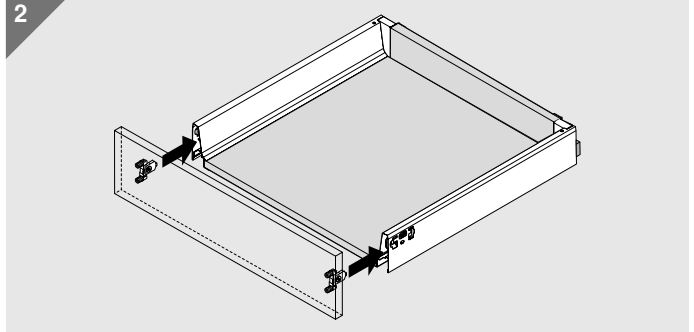
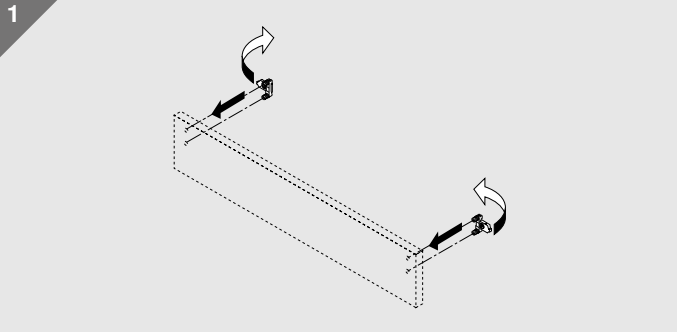

Height adjustment + side adjustment

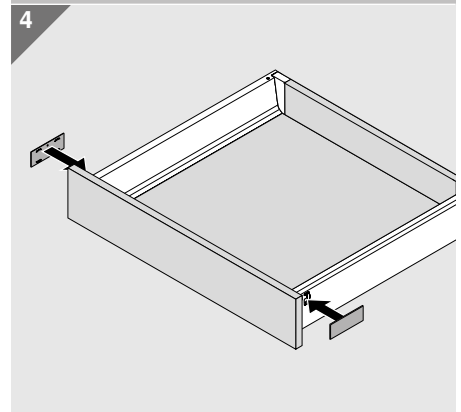
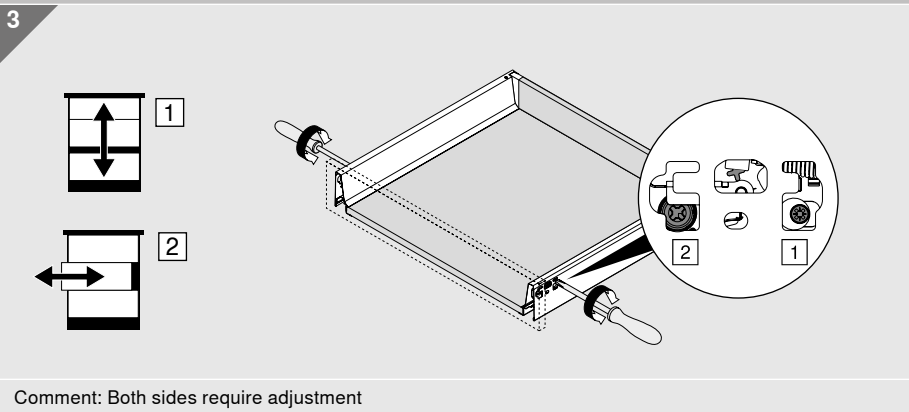

Inner drawer

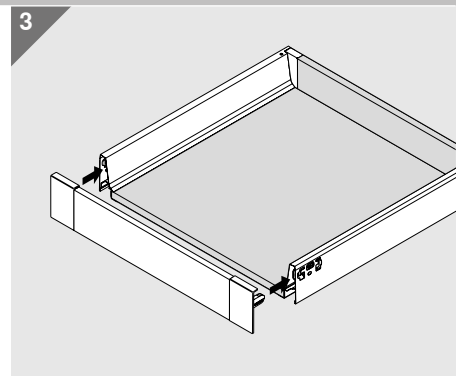
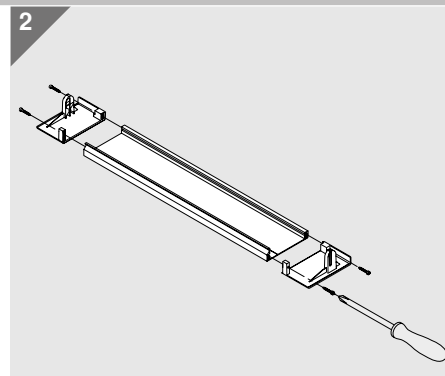
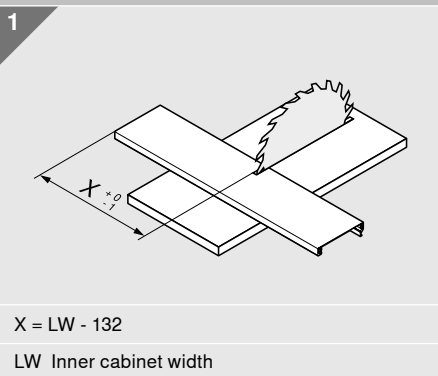

Locking piece

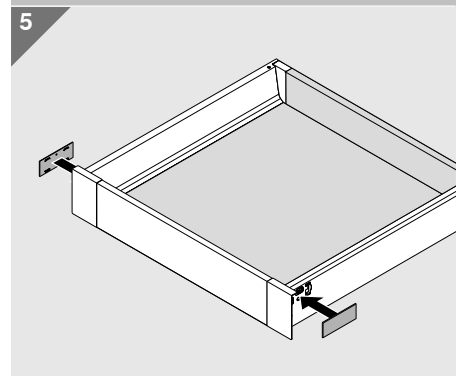
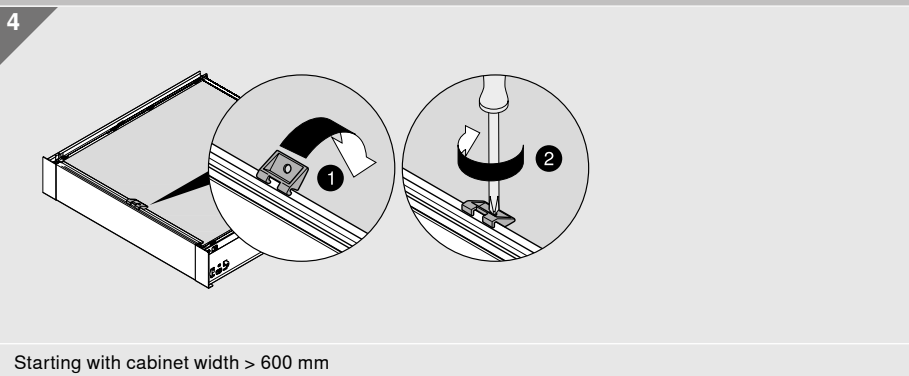

Handle and latch

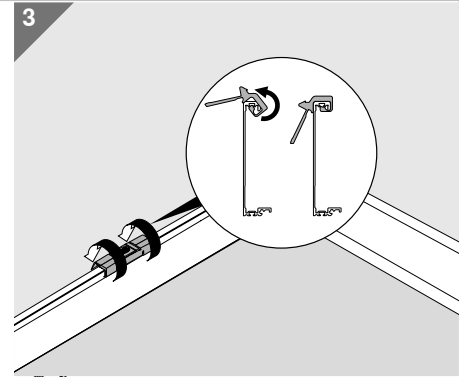
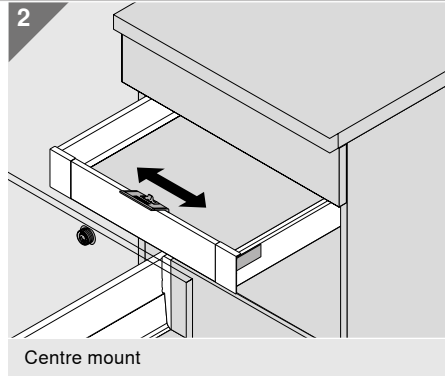
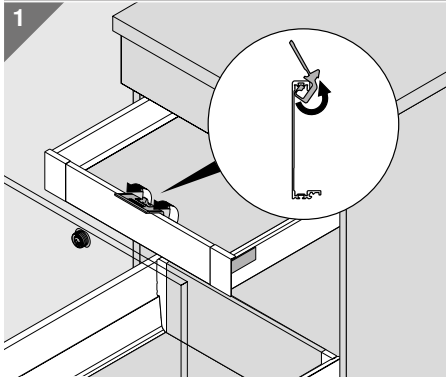

Latch activated

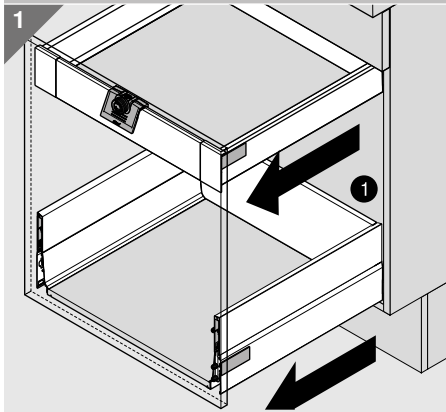

Release

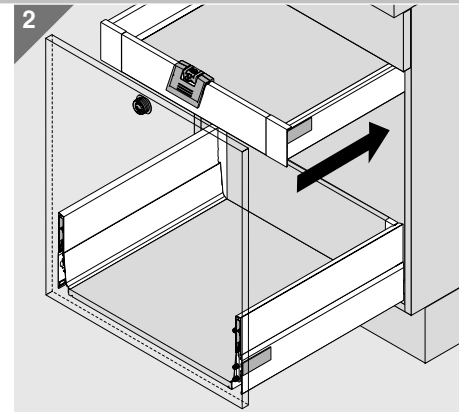
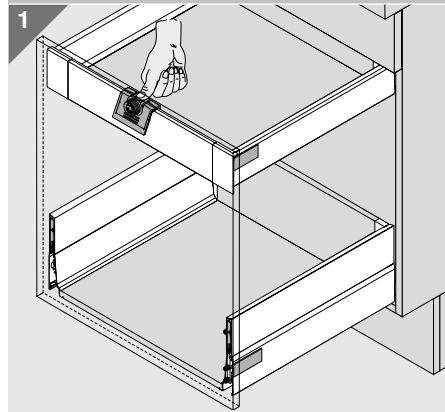

Deactivate latch

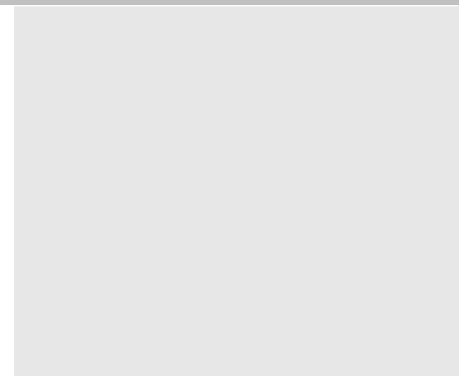
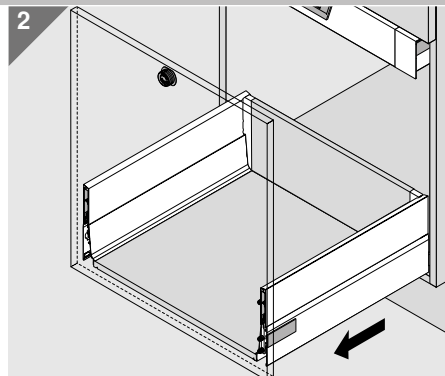
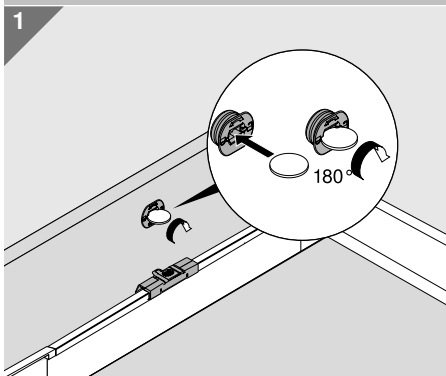

Front removal

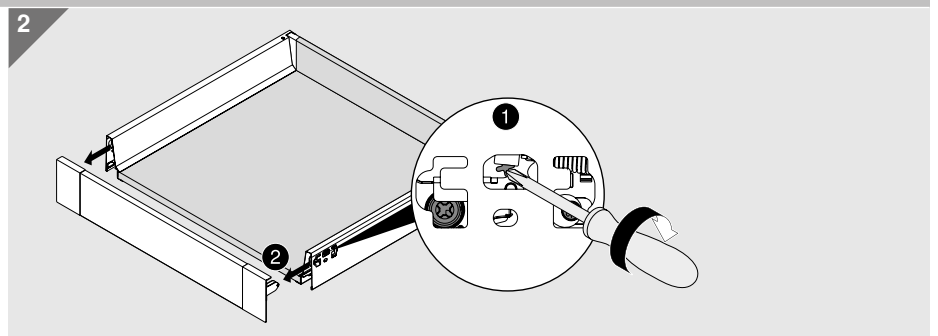
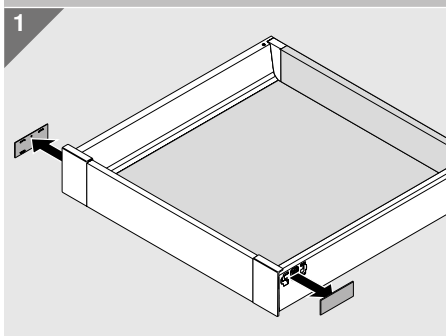

The company Blum

Founded over 60 years ago by Julius Blum, Blum is a family-owned company that operates on an international scale. Its strategic business segments include lift, hinge and pull-out systems. All our product developments focus on perfecting motion.

www.blum.com

 **blum**





Blum in Austria and around the world

The company has seven plants in Vorarlberg, Austria, additional production sites in Poland, the USA and Brazil and 29 subsidiaries/representative offices. Blum supplies more than 120 markets. The Blum Group employs 7.300 people in total, 5.500 of whom work in Vorarlberg.



Global customer benefits

“Whether manufacturer, distributor, fitter or kitchen user – everybody should personally enjoy the benefits of Blum products” – that is Blum’s philosophy on global customer benefits.



Innovations

To support customers with innovative fittings solutions and secure long-term success for the company, we need to consistently invest in research and development, in plants and facilities and in employee training. With more than 2.600 patents worldwide, Blum is one of Austria’s most innovative companies.



Quality

Blum’s comprehensive concept of quality does not only apply to products. Services and collaboration with customers and partners should also meet the same quality requirements.



Environment

At Blum, we believe that responsible ecological behaviour has long-term economic benefits. The longevity of products is just one of many important aspects. Other important measures include the use of environmentally-friendly processes, the intelligent use of materials and prudent energy management.



DYNAMIC SPACE

Good workflows, optimum use of storage space and top quality motion are important features of a practical kitchen. Blum’s ideas for practical kitchens are designed to bring function, convenience and ergonomics to furniture interiors.



Julius Blum GmbH
Furniture Fittings Mfg.
6973 Höchst, Austria
Tel.: +43 5578 705-0
Fax: +43 5578 705-44
E-mail: info@blum.com
www.blum.com

